



**2024**  
**OPEN CLASS**  
**COMPETITION RULES**

**JULY 28 - AUGUST 4, 2024**

[www.FairAndRodeoFun.com](http://www.FairAndRodeoFun.com)

# 2024 Douglas County Fair & Rodeo Competition Rules

<b>SECTION 1 DOUGLAS COUNTY FAIR AND RODEO COMPETITION RULES.....</b>	<b>4</b>
INTRODUCTION .....	4
GENERAL COMPETITION RULES .....	4
DEFINITIONS .....	5
ENTRIES & ENTRY FORMS .....	5
EXHIBITOR AND COMPETITOR CONDUCT .....	5
DISPUTES .....	6
DETERMINATION OF VIOLATIONS/PENALTIES.....	6
POSSIBLE PENALTIES FOR RULE INFRACTIONS .....	7
INFRACTION SUB-COMMITTEE .....	7
PROTESTS.....	7
CONCESSIONS AND ADVERTISING PRIVILEGES .....	8
DOGS .....	8
MOTORIZED UTILITY VEHICLES.....	9
OBJECTIONABLE EXHIBITS .....	9
<b>SECTION 2 – OPEN CLASS DIVISION ADDITIONAL RULES.....</b>	<b>10</b>
DEPARTMENT PROVISIONS.....	10
GENERAL COMPETITION RULES .....	10
ELIGIBILITY .....	10
ENTRIES .....	11
<b>AGRICULTURE DEPARTMENT A .....</b>	<b>12</b>
DEPARTMENT PROVISIONS.....	12
DIVISIONS .....	12
AGRICULTURE EXHIBIT CLASS .....	13
APIARY DIVISION.....	13
CORN DIVISION .....	13
EGG DIVISION .....	13
FORAGE CROPS.....	14
FRUIT DIVISION.....	14
VEGETABLE DIVISION .....	14
VINE CROPS .....	16
HERBS DIVISION.....	17
PREMIUMS.....	18
<b>FLORICULTURE DEPARTMENT B .....</b>	<b>19</b>
DEPARTMENT PROVISIONS.....	19
DIVISIONS .....	20
ARTISTIC ARRANGEMENTS .....	20
CUT FLOWERS.....	21
POTTED PLANTS .....	23
PREMIUMS.....	24
<b>FINE ARTS - DEPARTMENT FA .....</b>	<b>25</b>
DEPARTMENT PROVISIONS.....	25
PREMIUMS.....	25
FINE ARTS .....	25
YOUTH CLASSES BY GRADE .....	26
<b>CRAFTS - DEPARTMENT CR.....</b>	<b>27</b>
DEPARTMENT PROVISIONS.....	27

# 2024 Douglas County Fair & Rodeo Competition Rules

PREMIUMS.....	27
CRAFTS .....	27
YOUTH CLASSES BY GRADE .....	29

## **PHOTOGRAPHY - DEPARTMENT PH..... 30**

DEPARTMENT PROVISIONS.....	30
PREMIUMS.....	30
PHOTOGRAPHY .....	30
YOUTH CLASSES BY GRADE .....	32

## **BAKING - DEPARTMENT BK..... 33**

DEPARTMENT PROVISIONS.....	33
PREMIUMS.....	33
QUICK BREADS.....	33
YEAST AND SOURDOUGH BREADS .....	34
CAKES.....	34
COOKIES.....	34
PIES .....	35
CANDY .....	35
YOUTH CLASSES BY GRADE .....	35
COMMISSIONERS COOKIE JAR.....	35

## **CANNING - DEPARTMENT CN..... 37**

DEPARTMENT PROVISIONS.....	37
PREMIUMS.....	37
FRUITS.....	38
VEGETABLES .....	39
RELISHES .....	39
PICKLES .....	41
BUTTERS .....	39
JAMS .....	40
JELIES .....	40
PRESERVES.....	40
MARMALADES .....	40
MISCELLANEOUS .....	41
YOUTH CLASSES BY GRADE .....	41

## **HOME ARTS - DEPARTMENT HA..... 42**

DEPARTMENT PROVISIONS.....	42
PREMIUMS.....	42
SEWING .....	42
CROCHET .....	45
EMBROIDERY .....	43
NEEDLEWORK .....	46
KNITTING .....	44
RUGS.....	44
MISCELLANEOUS .....	44
YOUTH CLASSES BY GRADE .....	47

## **QUILTS - DEPARTMENT Q..... 46**

DEPARTMENT PROVISIONS.....	46
PREMIUMS.....	47
LARGE QUILTS.....	47

## 2024 Douglas County Fair & Rodeo Competition Rules

SMALL QUILTS .....	50
HAND QUILTED .....	48
GROUP QUILTS .....	48
MINIATURE QUILTS.....	49
QUILTED CLOTHING .....	51
QUILTED ACCESSORIES .....	49
ART QUILTS .....	49
YOUTH QUILTS BY GRADE.....	49
FIRST TIME COMPETITION ENTRY AWARDS DIVISION .....	49
<b>SENIORS - DEPARTMENT S.....</b>	<b>51</b>
DEPARTMENT PROVISIONS.....	51
PREMIUMS.....	51
SENIORS.....	51

**SECTION 1**  
**DOUGLAS COUNTY FAIR & RODEO COMPETITION RULES**  
**APPLIES TO ALL DIVISIONS, DEPARTMENTS AND COMPETITIONS**

**I. INTRODUCTION**

- A. The following terms, conditions, rules apply to all departments and to all competitions at the Douglas County Fair & Rodeo.
- B. Every exhibitor or competitor at the Douglas County Fair & Rodeo shall comply with the competition rules herein and comply with the more specific rules set forth in each Department.
- C. Person or persons, who violate any of the Competition Rules herein, may be subject to discipline as set forth in these rules and may be vacated or removed and ineligible for competition.
- D. Smoking is not allowed in any public buildings, or within 100' of any building entrance.
- E. Alcohol will be sold in designated areas on the Fairgrounds during the Douglas County Fair & Rodeo. Alcohol cannot be consumed or carried outside premised areas designated by signage.
- F. Any public display of photos or video of any Douglas County Fair & Rodeo event, concert, or rodeo for public dissemination without express written consent from the Douglas County Fair & Rodeo Management is strictly prohibited.
- G. All guests, contestants and participants are subject to a search by security personnel.
- H. The current Douglas County Fair & Rodeo Competition Rules will be posted on [www.douglascountyfairandrodeo.com](http://www.douglascountyfairandrodeo.com).

**II. GENERAL COMPETITION RULES**

- A. The Douglas County Fair does not discriminate on the basis of race, creed, color, sex, age, or other non-merit factors.
- B. Sleeping in livestock and horse barns are strictly forbidden.
- C. No fireworks are allowed.
- D. Warning: Under Colorado law, it is a crime to sabotage or to tamper with, administer growth stimulation drug(s) to, substitute unauthorized animal(s) for exhibition livestock, pursuant to CRS Section 18-9-10 7. Penalties include up to eighteen (18) months in prison or a fine up to one hundred thousand dollars (\$100,000) and the name and photograph of any convicted person (s) to be available for publication in newspapers and trade journals.
- E. Warning: Under Colorado law, equine or llama professionals and activity sponsors are not liable for any injury to or death of a participant in equine activities resulting from the inherent risks of equine activities pursuant to section 13-21-119, Colorado Revised Statutes.
- F. Douglas County Fair & Rodeo Management is not responsible for any loss, damage or injury to any person or property while on Douglas County grounds or real property.
- G. An exhibitor or competitor acknowledges and agrees to abide by all Competition Rules when they sign up to participate in any way in the Fair and anyone who has not done so will not be allowed to participate.
- H. **Exhibitors and competitors hereby indemnify the Douglas County Fair & Rodeo Management from any and all legal proceedings in regard to a challenge to any Competition Rules.**
- I. Exhibits must be stalled, penned, or exhibited only in areas and locations assigned to that exhibitor by Douglas County Fair & Rodeo Management. Exhibits not in authorized locations will be removed

## 2024 Douglas County Fair & Rodeo Competition Rules

by the Douglas County Fair & Rodeo Management without notice and the exhibitor may be subject to disciplinary action.

- J. Exhibits may not be removed prior to 5:00pm on the final day of Fair.
- K. Every animal or article shall be entered and exhibited in the name of its bona fide owner.
- L. Douglas County Fair & Rodeo Management reserves the right to cancel events or change scheduling if deemed necessary. Specific or special competition rules or conditions are published in each department where necessary.

### III. DEFINITIONS

- A. Douglas County Fair & Rodeo Management: this term includes the Fair Board Directors, Fairgrounds Manager, Fair Coordinator, Superintendent, administrative staff, however the primary enforcement of these Competition Rules on a day-to-day basis is the Fair Board.
- B. Department Superintendent/Assistant Superintendent: Person appointed by Fair Board that oversees a specific department, division, or contest at the County Fair.
- C. Judge: an individual who is selected to judge items or animals based on his/her expertise.
- D. Junior Division Exhibitor: Douglas County 4-H Member and/or Douglas County FFA member competing in the Douglas County Fair and Rodeo.

### IV. ENTRIES & ENTRY FORMS

- A. Competitions are open to the world except where otherwise specified.
- B. All entries must be completed on regulation forms, properly filled out.
- C. Entry forms for Open Class Division Competitions are available at the Douglas County Fairgrounds Office prior to entry day. On entry day forms and assistance will be available at the Events Center during entry hours.
- D. No article will be entitled to a place on the grounds until proper entry has been made.
- E. Douglas County Fair & Rodeo Management assumes no responsibility for errors on the entry forms.
- F. Every participant expressly understands and agrees that a completed entry form is acceptance of these Competition Rules and further agrees and understands that they will abide by these Rules throughout the duration of their time at the Douglas County Fair & Rodeo. It is understood that non-compliance with these Competition Rules may subject any participant to penalties up to and including exclusion from future participation.
- G. Late entries will not be accepted.
- H. The Douglas County Fair & Rodeo Management reserve the right to limit entries to facilities available, and to cancel any Department, division, or class in which, in its judgment, the entries are insufficient to secure adequate competition. The Douglas County Fair & Rodeo Management further reserves the right to return entries in the event any event competition, class or exhibit is cancelled.
- I. Customary care will be taken in handling entries. Entries will be shown at the artist's own risk.
- J. Open Class Division premiums will be paid in cash on the final day of Fair or must be picked up by one month after the Fair of the current year. Cash premiums not picked up by that date will be forfeited and returned to the General Fund of the Fair.

## **V. EXHIBITOR AND COMPETITOR CONDUCT**

- A. The Douglas County Fair & Rodeo Management expects all participants (including exhibitors, competitors, parents, volunteers, etc.) to abide by the stated Competition Rules for all activities and events, including, but not limited to the following:
  - 1. Conduct themselves in a courteous, respectful manner, using appropriate language, exhibiting good sportsmanship and providing positive role models.
  - 2. Adhere to Competition Rules, curfews and dress codes;
  - 3. Abstain from illegal and immoral behavior;
  - 4. Fully participate in scheduled activities;
  - 5. Refrain from physical or emotional child abuse or neglect;
  - 6. Apply safety regulations to individuals, groups and property; and
  - 7. Accept personal responsibility for behavior.
- B. Consequences may include penalties as set forth in these Competition Rules.

## **VI. DISPUTES**

- A. The Douglas County Fair & Rodeo Management are the final review and authority to interpret these Competition Rules and to settle questions of interpretation.
- B. There are additional specific competition rules set forth, if necessary, within each Department's competition section. Both may apply and if there is a conflict between them the Department rules will apply.
- C. In the event that references to external requirements, regulations, or rules conflict to these Douglas County Fair & Rodeo Competition Rules then the Douglas County Fair & Rodeo Competition Rules shall control over such conflicts.
- D. The following three types of disputes are addressed in the following:
  - 1. Pre-Fair rule infraction/violation.
  - 2. During Fair rule infraction/violation.
  - 3. Exhibitor, competitor, or contestant-initiated protest.
- E. Failure to meet the dates or deadlines set forth in these rules, subsequent to those published in attachments too are not grounds for disputes. All deadlines must be adhered to, see Appendix A: Master Schedule.

## **VII. DETERMINATION OF VIOLATIONS/PENALTIES**

- A. Whenever a violation of any competition term or Competition Rule has occurred or has been reported to have occurred, prior to or during the Douglas County Fair & Rodeo, it shall be reported first to the Department Superintendent, if possible for resolution, who will then elevate it to the Douglas County Fair & Rodeo Management if need be, to determine if, in fact, a violation has occurred. Only alleged violations reported within 24 hours of their occurrence will be investigated.
- B. If the Department Superintendent is unavailable, the alleged violation shall be reported to the Douglas County Fair & Rodeo Management.
- C. If in fact a rule infraction has occurred, the notified Douglas County Fair & Rodeo Management Representative shall inform the Fairgrounds Manager and the Douglas County Fair & Rodeo Board Chairman. If the infraction warrants an investigation, the Infraction Sub-Committee, identified in Section 1, XI, will be assembled to investigate and deliver a decision on the infraction.

## **2024 Douglas County Fair & Rodeo Competition Rules**

- D. The Infraction Sub-Committee shall investigate the infraction, conduct interviews with the affected parties and determine a resolution of the issue and identify if any penalty, as identified in Section 1, VIII, shall be applied.
- E. If the Infraction Sub-Committee shall generate a written response to the affected parties for the resolution for the Douglas County Fair & Rodeo Board Chairman's describing the infraction and the Infraction Sub-Committee's resolution.
- F. The affected parties shall be notified of the resolution and be informed of any penalty that was invoked.
- G. The Infraction Sub-Committee will present the issue and resolution to the Douglas County Fair & Rodeo Board for information only and to identify if the rule in question requires revision in the Competition Rules. The decision of the Infraction Sub-Committee is final.

### **VIII. POSSIBLE PENALTIES FOR RULE INFRACTIONS**

- A. The following penalties may be invoked for rule infractions:
  - 1. Written warning.
  - 2. The exhibitor or competitor in question is disqualified and could forfeit entry and other fees, trophies, and awards.
  - 3. The exhibitor or competitor shall be barred from competition at the Douglas County Fair & Rodeo for a predetermined period of time that may include a lifetime suspension from competition upon the concurrence of the Douglas County Fair Board.
  - 4. The exhibit in question will not be sold in any sales at the Douglas County Fair & Rodeo to include the Junior Livestock Sale.
  - 5. In the case of an exhibit already sold at the Douglas County Fair & Rodeo, the exhibitor or competitor shall refund and return all sale proceeds in excess of market value to the Douglas County Fair & Rodeo. The Douglas County Fair Board after conference with the Buyer shall determine the disposition of the remaining funds.
  - 6. Any combination of the above stated penalties.

### **IX. INFRACTION SUB-COMMITTEE**

- B. The following Infraction Sub-Committee will be assembled to investigate and render a decision when required:
  - 1. The Vice Chair of the Fair Board who shall serve as the presiding officer of the Infraction Sub-Committee (Voting Member).
  - 2. Superintendent of the affected department (Voting Member).
  - 3. One Douglas County Fair Board Director at large (preferable with knowledge in the affected department) (Voting Member).
  - 4. Fairgrounds Manager or representative strictly as an advisory role, who shall not have a vote.
  - 5. Two additional Douglas County Fair Board Directors at large (if the Vice Chair of the Fair Board determines that the situation warrants the additional assistance) (Voting Member).

### **X. PROTESTS**

- A. DECISIONS OF JUDGES ARE FINAL AND NOT ELIGIBLE FOR PROTEST.
- B. Whenever any person believes that an exhibitor, competitor, contestant, parent, or Fair Official has engaged in any activity that violates the Competition Rules of the Douglas County Fair & Rodeo or



## 2024 Douglas County Fair & Rodeo Competition Rules

engaged in any unethical activity during the course of the competition that may violate these rules, such person has the opportunity to provide their allegations of wrong-doing (protest) to the Douglas County Fair & Rodeo Management for review. Any person making such report must do so in writing (within 24 hours of the alleged infraction) and it must be personally presented to the Department Superintendent or a Douglas County Fair & Rodeo Management representative.

- C. Any protest must be accompanied by a one-hundred-dollar (\$100) bond (the “bond”) payable to the Douglas County Fair Foundation.
- D. The following is the Protest Procedure:
  - 1. The protest must be presented, in writing, and sworn to, within 24 hours or sooner, of the occurrence of alleged infraction for all activities and prior to the official closing of the Douglas County Fair & Rodeo.
  - 2. In the event a protest is presented after the judging has begun on the item or activity in question, the judging will proceed, and the protest will be handled as if the protest has been presented following the judging.
  - 3. The written protest must state the name of the exhibitor, competitor, contestant or fair official as applicable, who has allegedly committed a violation, or identified by the activity in question when the name is unknown to the reporting party. The protest shall include the exhibit, class in question, the specific allegations giving rise to the protest, the facts that support the protest with reference to Competition Rules as applicable.
  - 4. Upon receipt of a properly presented protest, the Douglas County Fair Board will appoint the Infraction Sub-Committee, identified in Section 1, XI, to review the protest and render a decision, the review process may include interview with the parties involved to assist in obtaining the facts associated with the filed protest.
  - 5. The decision on the Infraction Sub-Committee is final. (Written notice or record of the decision).
  - 6. In the discretion of the Infraction Sub-Committee, the bond may be returned to the individual who posted the bond or retained. If retained, the bond will be deposited in general funds of the Douglas County Fair Foundation.

## XI. CONCESSIONS AND ADVERTISING PRIVILEGES

- A. All exhibits, concessions, or commercial privileges are at the sole discretion of Douglas County Fair & Rodeo Management. Under no circumstances will any advertising matter be allowed to be placed upon buildings, trees, or other places on the grounds, or otherwise distributed, without management permission. Unauthorized advertising material may be immediately removed and disposed of, without recourse or notice.

## XII. DOGS

- A. Dogs are not allowed on the Fairgrounds during the Douglas County Fair & Rodeo with the following exceptions:
  - 1. Service Animals.
  - 2. Dogs on leashes will be allowed in the camping and trailer parking areas only. For their safety, dogs should not be tethered to a camper. A self-contained kennel is required for dogs staying in the camping area.
  - 3. Excessive barking or complaints of aggressive behavior will result in the dog being

## 2024 Douglas County Fair & Rodeo Competition Rules

excused from the Douglas County Fairgrounds. Excused dogs must be immediately removed from the Douglas County Fairgrounds.

4. Dogs that are competing or performing during the Douglas County Fair & Rodeo. Owners / Handlers must keep dogs under constant control and dogs ARE NOT allowed into any livestock barns, Kirk Hall, or the Events Center.

### **XIII. MOTORIZED UTILITY VEHICLES**

- A. NO personal golf carts or ATV's nor bicycles will be allowed on the fairgrounds during the Douglas County Fair & Rodeo.

### **XIV. OBJECTIONABLE EXHIBITS**

- A. The Douglas County Fair & Rodeo Management reserves the right to exclude from the grounds, any exhibit, animal, or entry that may be falsely entered, those deemed undesirable or objectionable, without assigning a reason.

#### **OFFICIAL ADDRESS AND PHONE NUMBER**

Douglas County Fair & Rodeo  
500 Fairgrounds Drive  
Castle Rock, CO 80104  
(720) 733-6900  
[fair@douglas.co.us](mailto:fair@douglas.co.us)

## SECTION 2

### OPEN CLASS DIVISION ADDITIONAL RULES

#### ARTS, CRAFTS, CULINARY, AGRICULTURE AND FLORICULTURE CONTESTS

APPLIES TO ALL DEPARTMENTS AND ARE IN ADDITION TO ANY DEPARTMENT, DIVISION AND CLASS

### I. DEPARTMENT PROVISIONS

- A. The following terms, conditions, and requirements apply to all Open Class Division Departments at the Douglas County Fair & Rodeo. These rules do not supersede or negate the Douglas County Fair & Rodeo General Competition Rules. All exhibitors must be familiar with all Douglas County Fair & Rodeo Competition Rules. Additional and specific Competition Rules are set forth within each individual Department's sections. Both general and specific Competition Rules shall apply to all competitions unless specifically noted otherwise.
- B. Every exhibitor entering into any competition at the Douglas County Fair & Rodeo shall comply with the Competition Rules as set forth below and shall comply with any additional or specific requirements or regulations as set forth for each, individual competition. Submission of an entry to the Douglas County Fair & Rodeo expressly binds the exhibitor to all terms and conditions contained in any and all parts of the Douglas County Fair & Rodeo Competition Rules.

### II. GENERAL COMPETITION RULES:

- A. EXHIBITOR CLASSIFICATION:
  1. The amateur and professional definitions are applied to the classes being entered. A person may be both an amateur and a professional (example: In the Crafts Department an exhibitor can be a professional in the Stained Glass class but an amateur in the Macrame class.). Professionals are not eligible for Best of Show or Best of Category awards.
    - a. **AMATEUR** – A person who engages in an activity as a hobby, not as a job.
    - b. **PROFESSIONAL** – A person with professional training; or an instructor; or a person who participates for gain or livelihood in an activity often engaged in by amateurs; or a person who pursues the activity as a full-time occupation.
  2. Age classification is determined as of August 1 of the current year. School grade classification is determined by the last grade completed as of August 1 of the current year.
    - a. Youth – 18 years & under as of August 1 of current year.
    - b. Open – 19 years & over as of August 1 of current year.
    - c. Senior Citizen – 55 years & over as of August 1 of the current year.

### III. ELIGIBILITY:

- A. ELIGIBILITY: Open Show Competition is open to the world, any group or individual.
  1. Youth exhibitors do not have to be enrolled in 4-H and may choose to be classified as Youth or Open for any entry in the Open Class Division. 4-H Youth Exhibitors are eligible and encouraged to enter current year items in Open Class as well as 4-H.

## 2024 Douglas County Fair & Rodeo Competition Rules

2. Articles or Items that have been exhibited in the Open Class Division at a previous Douglas County Fair & Rodeo are not eligible for competition at the current Douglas County Fair & Rodeo.
3. Junior Division Exhibitors who are Members in Good Standing may enter exhibits in the Open Class Division that competed in the Junior Division of last year's Douglas County Fair.
4. The exhibitor's or the minor exhibitor's parent/guardian's signature is required to certify that the entry is the exclusive work of the exhibitor.
5. The exhibitor's or the minor exhibitor's parent/guardian's signing the competition entry form(s) certifies that he or she has read and has been advised of the Douglas County Fair & Rodeo General Competition Rules, Open Class Division General Competition Rules, and special Department or Division Competition Rules.
6. All entries must be the work of the exhibitor.
7. Articles must be entered in the name of the person who made them.
8. Exhibitor signature certifies he or she has observed and agrees to Competition Rules regarding sabotage, tampering, prohibited substance, unethical fitting and agrees to observe and abide by all Competition Rules.
9. For the Open Class Division Llama/Alpaca Competition Rules, see the Junior Division Competition Rules, Department 27 Llama and Alpaca.

### IV. ENTRIES:

- A. Exhibitors are limited to one (1) entry per class, unless stated otherwise in the specific Department Requirements and Regulations.
- B. An exhibitor number will be assigned to each Exhibitor. This exhibitor number is to be used when entering all Open Class Departments. The exhibitor number must be on every entry form.
- C. Advance entries are NOT required for all Open Class Division.
- D. No article will be entitled to a place on the grounds until proper entry has been made.
- E. Superintendents and Judges may add, combine, or divide classes as necessary.
- F. In all classes entries will be judged and awarded on merit.
- G. Superintendents and Judges may move an entry to a different class/department if it has been wrongly entered or the entry would classify more correctly into a different existing class.
- H. Subject matter of entries must be appropriate for family friendly viewing. Inappropriate content or that which may be offensive to Fair patrons will not be accepted.
- I. The Douglas County Fair Board reserves the right to limit entries to facilities available and to cancel any department, division, or class in which, in its judgment, the entries are insufficient to secure adequate competition. The Douglas County Fair Board further reserves the right to return entries in the event any competition or class is canceled.
- J. The Douglas County Fair Board reserves the right to vacate as ineligible for competition and order the removal of any entry that has been entered in violation of these General Competition Rules or of any specific competition Rule.

**UNCLAIMED EXHIBITS:** Unclaimed exhibits will only be held for two weeks after Fair of the current year at the Douglas County Events Center Office, 500 Fairgrounds Drive, Castle Rock, CO 80104. After this deadline any unclaimed exhibits will be disposed of, and any unclaimed premium money will be forfeited and returned to the general funds of the Douglas County Fair.

## OPEN CLASS DIVISION AGRICULTURE

ALL EXHIBITS ARE IN THE EVENTS CENTER

JUDGING IS OPEN TO PUBLIC

### I. DEPARTMENT PROVISIONS

- A. All entrants must read, be familiar with, and comply with the Douglas County Fair & Rodeo General Competition Rules, Open Class Division General Competition Rules, and any special Division or Department Competition Requirements or Regulations. Fair Entry is Free. See the full schedule for dates and times for entering and judging.
- B. All exhibits must have been grown or produced by the exhibitor.
- C. Marijuana is prohibited in any agriculture or floriculture exhibit.
- D. Two entries per class will be accepted.

All dates and times below are tentative and subject to change. Please check the [www.douglascountyfairandrodeo.com/p/exhibitors/open-class](http://www.douglascountyfairandrodeo.com/p/exhibitors/open-class) for any updates.

#### **Exhibit Entry**

Open Division Agriculture and Floriculture Departments

Wednesday, July 31, 2024, from 5:00 pm to 8:00 pm in the Event Center

Thursday, August 1, 2024, from 7:00 am to 11:00 am in the Event Center

#### **Judging**

Open to the public Thursday, August 1, 2024, at 2:00 pm in the Events Center

#### **Exhibit Release**

All entries are released and available for pickup on the final Sunday of Fair at the Event Center between 5:00pm and 6:00pm.

#### **Payment of Premiums**

Exhibitors who win a placing ribbon, i.e. Blue (1<sup>st</sup>), Red (2<sup>nd</sup>), White (3<sup>rd</sup>), receive a cash award (premium). Exhibitors may collect payment for premiums and special other awards on the final Sunday of Fair at the Event Center between 5:00pm and 6:00pm.

### II. DIVISIONS

#### **AGRICULTURE PREPARATION INSTRUCTIONS**

The open class agriculture exhibits provide an opportunity for fair entrants to display the results of hard work cultivating farms and gardens and for attendees to learn about food and forage production in Douglas County and the region. Agriculture is a part of the heritage of Douglas County, and it is in its future too! While the motives for entering the agriculture division will vary from person to person, the purpose of the exhibits and friendly competition is to educate, inspire, and build up the gardening community. Most importantly, an agriculture show is FUN – whether you're an old-hand exhibitor or a novice, a blue-ribbon winner or not – relax, learn, and have fun.

## 2024 Douglas County Fair & Rodeo Competition Rules

Unless otherwise noted, exhibits in classes 18 and above must be entered on clear plastic plates.

- A. The Fruit, Herb, and Vegetable classes will be judged on freshness, uniformity, flavor, color, texture/firmness, and maturity as applicable. Individual exhibits must consist of all the same ripeness or greenness, and variety, as appropriate. For all classes follow rules and instructions for specifics: Number needed, height, weight, diameter, or length limits; trimmed or not; peeled: husked, or shelled; with or without stems, etc. For more appealing display, prepare exhibit as you would want to buy them: clean, not washed, free of foreign matter.
- B. 6" and 9" clear plastic plates will be provided.
- C. Herb stem length should be appropriate to herb variety (about 6-12"), except as noted. Herb foliage with or without flower according to conventional use.
- D. Fruit should have soil removed without scrubbing, polishing, or otherwise removing the natural "bloom".
- E. See additional rules in each division.
- F. Your entry may be reclassified.

### **AGRICULTURE EXHIBIT CLASS 1 DIVISION**

<b>Class</b>	<b>Class Name</b>	<b>Description</b>
1	Agriculture Exhibit	May be arranged by an individual, organization or community. Exhibit must contain at least 5 varieties (state varieties) from classes 2-72. Attractiveness to be considered. Exhibits must be in the Events Center by 11:00 AM Thursday, August 1. Exhibitor must furnish props.

### **APIARY DIVISION**

<b>Class</b>	<b>Class Name</b>	<b>Description</b>
2	Apiary	Comb Honey, 1 pound
3	Apiary	Strained Honey 1 pound with no debris or pollen

### **HELPFUL HINT**

- A. Honey should be displayed in a clear jar. Judges will taste for freshness and quality.

### **CORN DIVISION**

<b>Class</b>	<b>Class Name</b>	<b>Description</b>
4	Corn	Field Corn – 3 ears
5	Corn	Sweet Corn – 3 ears

### **EGG DIVISION**

<b>Class</b>	<b>Class Name</b>	<b>Description</b>
6	Eggs (Display in Carton)	Brown Eggs – 6
7	Eggs (Display in Carton)	White Eggs – 6
8	Eggs (Display in Carton)	Any Other Color – 6
9	Eggs (Display in Carton)	Duck Eggs – 6
10	Eggs (Display in Carton)	Green Eggs – 6

## 2024 Douglas County Fair & Rodeo Competition Rules

- 11 Eggs (Display in Carton) Any Other Eggs – 6

### HELPFUL HINTS

- A. Display in cartons. When cracked, egg white (Albumen) should not run, yolk should be high with no bloodspots. A deep golden yellow yolk is preferred to a light-yellow yolk.

### FORAGE CROPS DIVISION

Class	Class Name	Description
12	Forage Crops	Alfalfa Bundle – 3” diameter (state variety)
13	Forage Crops	Clover bundle – 3” diameter (state variety)
14	Forage Crops	Field Corn – 6 stalks (state variety)
15	Forage Crops	Heirloom Field Corn – 6 stalks (state variety)
16	Forage Crops	Any Forage Grasses Bundle - 3" diameter (state variety)
17	Forage Crops	Collection of Economically Valuable Grasses. Collection of 8 varieties displayed artistically in 3” diameter bundles each (state varieties).

### HELPFUL HINTS

- A. Display in bundle size as indicated.  
B. Corn stalks should show some buttress roots.

### FRUIT DIVISION

Class	Class Name	Description
18	Fruits	Pome – Apple, Crab Apples, Pears– 3 of any variety (state variety)
19	Fruits	Stone – Apricots, Peaches, Plums– 3 of any variety (state variety)
20	Fruits	Berries – ½ pint (state variety)
21	Fruits	Cherries, Chokecherries – ½ pint (state variety)
22	Fruits	Any Other Fruit - ½ pint (state variety)

### HELPFUL HINTS

- A. Apples and Crabapples - Show with stems attached. Fruit should be mature as indicated by their aroma and color. Fruits should be uniform and without blemishes. Remove leaves.
- B. Chokecherries and Cherries – Show with stems attached. Color should be deep, dark purplish-red. Color, uniformity, and proper maturity are critical factors.
- C. Raspberries - Show with stems and calyx segments attached. Fruits should not be exhibited without hulls. Collapsed fruit and dispersing aggregates are signs of over maturity.
- D. Strawberries - Should be mature, uniform and exhibited with caps.

### VEGETABLE DIVISION

Class	Class Name	Description
23	Vegetables	Snap Beans – Any Color - ½ pound (state variety)
24	Vegetables	Table Beets – 3 (state variety)

## 2024 Douglas County Fair & Rodeo Competition Rules

25	Vegetables	Broccoli – 1 Head (state variety)
26	Vegetables	Cabbage – 1 Head (state variety)
27	Vegetables	Carrots – 6 (state variety)
28	Vegetables	Peas – Snap, Snow, String, or any other, shelled - ½ Pound (state variety)
29	Vegetables	Cauliflower – 1 Head (state variety)
30	Vegetables	Garlic – 3 Heads (state variety)
31	Vegetables	Bulb Onions – 3 (state variety)
32	Vegetables	Green Onions – 6 (state variety)
33	Vegetables	Potatoes – 3 (state variety)
34	Vegetables	Tomatoes – 3 Unripe, Green (state variety)
35	Vegetables	Tomatoes – 3 Ripe (state variety)
36	Vegetables	Cherry Tomatoes – 6 (state variety)
37	Vegetables	Rhubarb – 3 Stalks (state variety)
38	Vegetables	Leafy Greens– 3 Stalks or 1 Head (state variety)
39	Vegetables	Eggplant – 1 (state variety)
40	Vegetables	Table Turnips – 3 (state variety)
41	Vegetables	Peppers – 3 Mild (state variety)
42	Vegetables	Peppers – 3 Hot (state variety)
43	Vegetables	Radishes – 6 (state variety)
44	Vegetables	Any Other Vegetables (state variety)
45	Vegetables	Vegetable Critter Art (state varieties used)

### HELPFUL HINTS

- A. Snap Beans: Pods should be well-formed, tender, firm and should snap when broken. Color should be bright, seeds should be small, and the flesh should not have any voids. Pods should be uniform in-shape and size with ½” of stem attached.
- B. Table Beets – Should have 1” petioles. Beet should be tender, smooth, free of side roots, have a small crown, and should be rounded, symmetrical and uniform. The root should not be removed. Size from 1” to 3.5” diameter.
- C. Broccoli – Stems are 6” and the head at least 3” in diameter. Stem should be solid and loose leaves removed. Head should be compact and dark green with tight uniform buds of medium size. No yellow color. Over maturity, looseness in head and damage to buds are to be avoided.
- D. Cabbage – Heads should be firm and solid with 2 to 3 wrapper leaves per head and small mid-veins, tightly formed. Stems should be cut ¼” below the head.
- E. Carrots – Should have 1” petioles remaining. Carrots should be small cored, straight, crisp and have deep color. The root should be clean and free of side roots. The skin should be smooth, the roots uniform and true to size and shape for variety. Avoid large crowns and green shoulders.
- F. Peas – ½ pound of podded peas with ½” stems attached. Select pods that are bright green and fully filled with well-sized but tender peas. Pods should be plump and firm and seeds sweet and tender.
- G. Cauliflower – One head at least 4” in diameter with 4 to 6 leaves to protect curd. Trim outer leaves slightly above head. The curd should be pure white, white, or color of cultivar, smooth, and compact. Avoid over maturity and openness. Stem should be trimmed ½” below the last remaining leaf.
- H. Garlic – Uniform, well-shaped and full sized. Brush off dirt, do not wash. Do not remove sheath. Cut off roots. Bulbs should have small, well-dried necks with 2” stem attached.



## 2024 Douglas County Fair & Rodeo Competition Rules

- I. Bulb Onions – Display with 2” to 3” of stem attached. Select uniform, solid, well-cured mature onions with intact dry skins and well-dried, tight necks. Harvest early and air dry thoroughly. Do not remove outer scales. Do not wash.
- J. Green Onions – ½” to 1” in diameter, clean, purple or white color, with dark green tops about 6” long. Remove loose skin, cut tops to 4” to 5” above white shank. The shanks should be long, straight and the bulb not enlarged. Peel only one outer wrapper. OK to wash. Trim roots to ½”.
- K. Potatoes – Firm, plump and no damage spots. Potatoes should be uniform with shallow eyes and smooth surface. Brush off dirt with soft brush. Do not wash.
- L. Tomatoes (unripe, green) – Should be uniform, firm and “mature green” with a slight pinkish color preferred to being green. Should be soil-free, but not washed or polished.
- M. Tomatoes (ripe) – Fruit should be uniform in size, color, firmness, and maturity. The interior bright and meaty with green gel around seeds. Tomatoes should be true to variety in size, shape, and color. The skins should be smooth and without growth cracks. Should be soil-free, but not washed or polished.
- N. Tomatoes (Cherry) – Fruits should be uniform in size, color, firmness, and maturity. Tomatoes should be true to variety in size, shape, color, and maturity.
- O. Leafy Greens – Dark green, crisp fresh leaves with bright, clean stems. Avoid dirty, wilted, poorly colored leaves with insect damage or the flowering stems present.
  - 1. Head of Lettuce – 1 Head – Crisp, good color, and firm. Trim stem evenly at base. Remove damaged outside leaves.
  - 2. Leaf lettuce – 3 Leaves – Tender, good color, clean, and fresh.
- P. Eggplant – Fruit should retain calyx cap and ½” of stem. A good quality eggplant is firm, heavy in relation to size, with a uniform color and small blossom scars. Should not be washed, but it should be cleaned with a soft cloth. Uniform color and patterning. Not overripe (seeds should not be brown/mature).
- Q. Turnips – Should be smooth with firm flesh, have a small crown, be free of side roots, round, crisp, and a color pattern typical of variety. They should be 2” to 2.5” in diameter with 1” petioles. The taproot should be untrimmed.
- R. Pepper (mild/hot) – ½” of stem should be attached. Fruit should be clean and firm with dark color (red, green, or yellow) and without blemishes. The peppers should be of uniform size and color, with even lobes (as applicable).
- S. Radishes – Should be smooth, firm, crisp, and free of side roots. Followed by uniform shape, color, and maturity. Should have 1” petiole remaining. The root should be clean.
- T. Rhubarb – Stalks should be uniform in size and color. Stalks should be pulled, not cut from plant. Leaf should be trimmed to show one inch of leaf at the end of each stalk.
- U. Vegetable Critter Art – Can be any parts of vegetables, including stems, leaves, and seeds. Fastened with small wood skewers only. No glue or tape. This a great class for all children and adults!

### **VINE CROP DIVISION - CUCURBIT**

<b>Class</b>	<b>Class Name</b>	<b>Description</b>
46	Vine Crops	Pickling Cucumbers – 3 (state variety)
47	Vine Crops	Slicing Cucumbers – 3 (state variety)
48	Vine Crops	Zucchini Squash – 3 (state variety)
49	Vine Crops	Largest Zucchini – 1 (state variety)

## 2024 Douglas County Fair & Rodeo Competition Rules

50	Vine Crops	Yellow Squash – 3 (state variety)
51	Vine Crops	Other Summer Squash – 3 (state variety)
52	Vine Crops	Acorn Squash – 1 (state variety)
53	Vine Crops	Hubbard Squash – 1 (state variety)
54	Vine Crops	Spaghetti Squash – 1 (state variety)
55	Vine Crops	Field (ornamental or forage) Pumpkins – 1 (state variety)
56	Vine Crops	Pie Pumpkins – 1 (state variety)
57	Vine Crops	Other Winter Squash – 1 (state variety)

### HELPFUL HINTS

- A. Cucumbers – Straight, uniform size and color typical of variety. Fruit should be crisp, firm, and free of insect or mechanical damage. Trim stem to ½". Wipe with soft cloth to clean.
  1. Pickling: 2" to 4" in length, with straight even spines.
  2. Slicers: 6" to 10" in length, not to exceed 2.5" in diameter. No mature seeds.
- B. Summer squash or Zucchini– Zucchini should be 6" to 9" long. Yellow or straight neck squash should be 5" to 6" long. Scalloped or pattypan squash should be 3" to 4" in diameter. Each entry should have ½" of stem attached, with the skin tender and seeds immature and edible. Flesh should be solid, light colored, and free of voids.
- C. Field or Pie Pumpkins – Pumpkins should have a thick flesh and be heavy for size. A 2" stem must be attached. Fruit should be smooth and mature, showing full ripe color. The skins should be resistant to thumbnail puncture. Wipe and polish with a soft cloth. Field pumpkins are any pumpkin grown for decorative purposes or as livestock forage, regardless of size; pie pumpkins are grown for human consumption.
- D. Winter squash – Should be mature and have 2" stem attached. Skin should be hard and soil free.

### HERBS DIVISION

Class	Class Name	Description
58	Herbs	Basil – 3 Sprigs (state variety)
59	Herbs	Mint – 3 Sprigs (state variety)
60	Herbs	Chives – 12 Sprigs (state variety)
61	Herbs	Oregano – 3 Sprigs (state variety)
62	Herbs	Sage – 3 Sprigs (state variety)
63	Herbs	Thyme – 3 Sprigs (state variety)
64	Herbs	Marjoram – 3 Sprigs (state variety)
65	Herbs	Flat Leaf Parsley – 3 Sprigs (state variety)
66	Herbs	Curly Leaf Parsley – 3 Sprigs (state variety)
67	Herbs	Rosemary – 3 Sprigs (state variety)
68	Herbs	Tarragon – 3 Sprigs (state variety)
69	Herbs	Cilantro – 3 Sprigs (state variety)
70	Herbs	Dill (leaf) – 3 Leaves (state variety)
71	Herbs	Dill (seed) – 3 Heads (state variety)
72	Herbs	Any other herb – 3 Sprigs (state variety)
73	Herbs	Herb Collection – Collection of 5 varieties of fresh herbs artistically displayed with 3 sprigs of each. (state varieties)

## 2024 Douglas County Fair & Rodeo Competition Rules

### HELPFUL HINTS

- A. Select sprigs with leaves that are clean and free of blemishes.
- B. Dill - Select large mature heads with green seeds "going" brown. Cut seed heads with 10" to 12" stems.
- C. Herbs used in displays must be grown by entrant.

### III. PREMIUMS

- A. Agriculture Exhibit Class 1 and Herb Collection Class 73
  - 1. Ribbons will be awarded in 1<sup>st</sup> thru 3<sup>rd</sup> place
  - 2. **PREMIUMS:** 1st-\$5, 2nd-\$3, 3rd-\$1
  - 3. Rosette: Best of Show
- B. Classes 2-72
  - 1. Ribbons will be awarded in 1<sup>st</sup> thru 3<sup>rd</sup> place
  - 2. **PREMIUMS:** 1st-\$5, 2nd-\$3, 3rd-\$1
  - 3. Rosette: Best of Show, awarded for the following categories:
    - a. Overall Best of Show, Agriculture
    - b. Overall Youth Best of Show, Agriculture
    - c. Best Herb
    - d. Best Display of Herbs
    - e. Biggest Tomato
    - f. Most Unique Vegetable
    - g. Best Quality Fruit
    - h. Best of the Most (Most Ribbons Awarded for Agriculture Entries)
    - i. Most Entries, entrant over 55 years of age
    - j. Most Entries, entrant under 55 years of age

## OPEN CLASS DIVISION FLORICULTURE

### ALL EXHIBITS ARE IN THE EVENTS CENTER - JUDGING OPEN TO PUBLIC

During the fair in the floriculture open class display, gardeners and non-gardeners alike will see a wide variety of flowers, arrangements, and plants that can be grown in our region and beyond. This educational and inspirational opportunity is the purpose of the exhibition, allowing growers to display the fruits of the labors and to compare their results, commiserate in hardships, and enjoy camaraderie with other gardening enthusiasts. For many, the honor of displaying (and placing) in the competition is the only reward sought, for others, the prizes and awards, though small, are motivating. Whatever your own reason for exhibiting and visiting the division, **the goal of the show** is to inspire and educate, and for everyone, exhibitors and non-exhibitors alike, **to have fun.**

### I. DEPARTMENT PROVISIONS

- A. All entrants must read and be familiar with, and comply with, the Douglas County Fair & Rodeo General Competition Rules, Open Class Division General Competition Rules, and any special Division or Department Competition Requirements or Regulations.
- B. See Additional Instructions on Timing and Premiums in the Agriculture section.
- C. All exhibits must have been produced by the exhibitor. Plants in classes 9-73 must have been grown by the exhibitor for at least 2 months; plants in classes 74 and above for at least 3 months.
- D. Commercially grown cut flowers will not be eligible in classes 9-73.
- E. Commercially grown cut flowers shall be eligible in classes 1-8.
- F. Exhibitors may enter TWO (2) entries per class
- G. Designations (unless otherwise noted):
  - 1. S – Small – under 3”
  - 2. L – Large – over 3”
  - 3. Follow rules of presentation for requirements such as ‘spray’ vs. ‘stem’.
    - a. Spray: A multiple-branched specimen with at least two open blooms and with or without buds.
    - b. Stem: A single-branched specimen with a single bloom and no other buds.
  - 4. Overall size – means in all directions, unless otherwise indicated.
    - a. Containers/planters do not count toward height in potted plant classes.
  - 5. Containers are furnished for small cut flower entries.
- H. Marijuana is prohibited in any agriculture or floriculture exhibit.

### HELPFUL HINTS

- 1. To prepare flower exhibits properly, cut with a sharp knife after sundown or in early morning. Cut at peak of maturity, that is, when the main bloom or blooms is/are  $\frac{3}{4}$  open.
- 2. Plunge immediately into tepid or warm water (100 degrees F), and place in a cool dark place out of drafts for at least 8 hours prior to showing to allow time for the flower to recover full turgor.
- 3. Flowers that wilt easily should be collected the morning of the show.
- 4. Plants and cut flowers may be cleaned/groomed, though leaf dressing/shine is not allowed. Do not show plants with damaged leaves or spent flowers; they should be removed or trimmed as

## 2024 Douglas County Fair & Rodeo Competition Rules

inconspicuously as possible. (A small blemish on an otherwise perfect specimen, though, will not remove it from contention.)

5. All specimens should be clean, and free from insect and disease damage or other blemishes.
6. No leaves should be submerged in the display vase.
7. Plants must be properly labeled on the entry tag. Genus species (botanic name) is preferred to aid in classification, but common names are acceptable. Provide as much information as possible, including variety name (remember to save those nursery tags and seed packets for reference!).

Examples: Best: Tagetes patula 'Dwarf Sparky'

Better: French Marigold, Dwarf Sparky

Good: Marigold, Dwarf Sparky

Acceptable: Marigold

8. How Judges Evaluate Entries: Entries are not judged against one another directly, but are judged according to how closely each approaches the "ideal" for the variety. If no entries in a particular class are sufficiently close to the ideal standard, top placings may not be awarded at the judge's discretion. Entries may be reclassified if necessary—judges/superintendents may subdivide and combine classes at their discretion to make class size and judging more manageable, and move incorrectly entered plants to the correct class in order to make entries competitive for awards.

In general, judges look at:

- i. Condition: Plants are at peak bloom and free from disease, insects, mechanical, or other damage, including dirt, stain, and blemish.
- ii. Form: Plants and flowers are at proper maturity and correct shape for variety.
- iii. Stem and Foliage: Stems should be straight and in proportion to flowers, not damaged.
- iv. Color: Color should be true to type, intense, and brilliant.
- v. Size: Blooms and foliage should be the proper size for the variety and proportional. Where multiple specimens are required, they should be as uniform as possible.
- vi. Additional characteristics for particular classes are listed in "Helpful Hints" for each class when appropriate.

## II. DIVISIONS

### ARTISTIC ARRANGEMENTS

Class	Description
-------	-------------

- |   |   |
|---|---|
| 1 | Miniature Arrangement under 3" tall overall   |
| 2 | Table Arrangement under 12" tall overall (Centerpiece)  |
| 3 | Traditional Arrangement up to 36" tall  |
| 4 | Contemporary Arrangement up to 36" tall.  |
| 5 | Celebrate Heroes <ol style="list-style-type: none"><li>a. A display of any plant material in an unusual or decorated garden container utilizing symbols or identifiers in honor of any hero</li></ol> |
| 6 | Western Natives - Celebrate "The West" - Be Creative! <ol style="list-style-type: none"><li>a. Plants used should be native to the Western U.S.A</li></ol>  |
| 7 | Celebrate Red, White, and Blue  |

## 2024 Douglas County Fair & Rodeo Competition Rules

- a. A Red, White, and Blue arrangement paying tribute to the USA
- 8 Terrarium
  - a. Fairy Gardens

### HELPFUL HINTS

- A. Judging to include container and decoration depicting the theme
- B. Design: Balance, scale, composition, and proportion: Overall design is seen as one complete piece, pleasing to the eye and enjoyable to look at.
- C. Color harmony: Harmony of color used to create attractiveness.
- D. Conformance: Suitability to the class description.
- E. Traditional Arrangement: Bouquet of cut flowers arranged in container.
- F. Contemporary Arrangement: Modern floral design, architectural features, artistic, structural design.
- G. Originality and self-expression: Creativity, self-expression, and interpretation of the class theme.
- H. Texture harmony of materials: Relationship between the elements used: Flowers, foliage, container, and accessories in a design.
- I. Relation to container: Proper scale and proportion to container.
- J. Condition: Freshness and quality of all materials used: flowers, foliage, containers, ribbons, and other accents.

### CUT FLOWERS

#### ANNUALS

<b>Class</b>	<b>Description</b>
--------------	--------------------

- |    |  |
|----|--|
| 9  | Bachelor Button – 3 Stems (state variety)  |
| 10 | Bells of Ireland – 3 Sprays (state variety)                                      |
| 11 | Calendula – 3 Stems (state variety)  |
| 12 | Cockscomb – 3 Stems (state variety)  |
| 13 | Cosmos – 3 Stems (state variety)   |
| 14 | Dianthus – 3 Sprays (state variety)  |
| 15 | Larkspur – 3 Sprays (state variety)  |
| 16 | Marigold small – 3 Stems – under 3” (state variety)                              |
| 17 | Marigold large – 3 Stems – over 3” (state variety)                               |
| 18 | Nasturtium – 3 Sprays (state variety)  |
| 19 | Nicotiana – 3 Sprays (state variety)   |
| 20 | Ornamental Grasses – 3 Spikes (state variety)                                    |
| 21 | Pansies (Viola x wittrockiana) – 3 Stems (state variety)                         |
| 22 | Viola (Viola pedunculata) or any other species violets – 3 Stems (state variety) |
| 23 | Pelargonium (Geranium) – 1 Spray (state variety)                                 |
| 24 | Petunia – 3 Sprays (state variety)   |
| 25 | Poppy – 3 Stems (state variety)  |
| 26 | Rudbeckia – 3 Sprays or Stems (state variety)                                    |
| 27 | Salvia – 3 Sprays (state variety)  |
| 28 | Snapdragon – 3 Sprays (state variety)  |
| 29 | Sunflower small – 3 Stems – under 6” (state variety)                             |

## 2024 Douglas County Fair & Rodeo Competition Rules

- 30 Sunflower large – 1 Stem – over 6” (state variety)
- 31 Zinnia small – 3 Stems – single color – under 3” (state variety)
- 32 Zinnia large – 3 Stems – single color – over 3” (state variety)
- 33 Zinnia small – 3 Stems – bicolor – under 3” (state variety)
- 34 Zinnia large – 3 Stems – bicolor – over 3” (state variety)
- 35 Any other annual in the aster family (Asteraceae) (not listed above) – 3 Stems (state variety)
- 36 Any Other Annual Cut Flower – 1 Stem (state variety)

### PERENNIALS

Class	Description
-------	-------------

- |    |   |
|----|---|
| 37 | Bellflower – 3 Sprays (state variety)   |
| 38 | Columbine – 3 Stems (state variety)   |
| 39 | Coneflower - purple (Echinacea) – 1 Stem (state variety)  |
| 40 | Coneflower - Yellow (Rudbeckia and Ratibida) – 1 Stem (state variety)                                       |
| 41 | Coneflower - other Colors (Echinacea) – 1 Stem (state variety)  |
| 42 | Coreopsis – 3 Stems (state variety)   |
| 43 | Daisy (White) – 3 Stems (state variety)   |
| 44 | Hydrangea - 1 Spray (state variety)   |
| 45 | Delphinium – 1 Spray (state variety)  |
| 46 | Dianthus – 3 Sprays (state variety)   |
| 47 | Gaillardia – 3 Stems (state variety)  |
| 48 | Ornamental Grasses - 3 Spikes (state variety)   |
| 49 | Liatis (Gayfeather) -1 Spike (state variety)  |
| 50 | Penstemon – 3 Sprays (state variety)  |
| 51 | Phlox – 3 Sprays (state variety)  |
| 52 | Roses: Hybrid Tea and Grandiflora – 1 Stem or 1 Spray (state variety)                                       |
| 53 | Roses: Floribunda and Polyantha – 1 Spray (state variety)   |
| 54 | Roses: Miniature and Miniflora – 1 Spray or 1 Stem (state variety)  |
| 55 | Roses: Shrub – 1 Spray or 1 Stem (state variety)  |
| 56 | Roses: Rambling and Climbing – 1 Spray or 1 Stem (state variety)  |
| 57 | Roses: Heritage and Old Garden Roses – 1 Spray or 1 Stem (state variety)                                    |
| 58 | Violets – 3 Stems (state variety)   |
| 59 | Yarrow – 3 Sprays (state variety)   |
| 60 | Any other perennial in the aster family (Asteraceae) (not listed above) – 1 Spray or 1 Stem (state variety) |
| 61 | Any Other Perennial – 1 Spray or 1 Stem (state variety)   |
| 62 | Flowering Shrubs with blossoms –1 Spray or 3 Stems (state variety)  |
| 63 | Culinary Herbs with flowers – 1 Spray or 1 Stem (state variety)   |
| 64 | Salvia and other mints (not listed above) –1 Spray or 3 Stems (state variety)                               |
| 65 | Ornamental Fruit – 1 Spray or 1 Stem (state variety)  |

### BULBS, CORMS, TUBERS, FLESHY ROOTS

Class	Description
-------	-------------

- |    |  |
|----|--|
| 66 | Dahlia small – 1 Stem – under 3” (state variety) |
|----|--|

## 2024 Douglas County Fair & Rodeo Competition Rules

- 67 Dahlia medium – 1 Stem – 3” to 6” (state variety)
- 68 Dahlia large – 1 Stem – over 6” (state variety)
- 69 Daylily – 1 Spray (state variety)
- 70 Gladiolus any color – 1 Spray (state variety)
- 71 Lily – 1 Spray (state variety)

### HELPFUL HINTS

- A. Ornamental grasses are judged on the flower spike or the seed heads.
- B. Heritage and Old Garden Roses are varieties introduced prior to 1867 or of unknown introduction date.
- C. Culinary Herbs are judged on floral quality.
- D. Ornamental Fruits are judged on aesthetic value. Fruits should be entered on stems (not detached). Choose fruits that are symmetrical and well proportioned, with brilliant color appropriate to variety. Fruits in this class may be dried or fresh, as appropriate for variety and ornamental value. Examples include, but are not limited to: Lunaria (money plant), Cephalanthus (buttonbush), and Viburnum.

### FOR CHILDREN 12 AND UNDER ONLY

#### **Class Description**

- 72 The Biggest Bloom – 1 Stem
- 73 The Smallest Bloom – 1 Stem

### POTTED PLANTS

#### **Class Description**

- 74 African Violets – Relatives of African violets (Gesneriads) (state variety)
- 75 Pelargoniums and Geraniums (state variety)
- 76 Begonias (state variety)
- 77 Small Houseplant in Bloom – under 12” tall overall (state variety)
- 78 Large Houseplant in Bloom – over 12” tall overall (state variety)
- 79 Small Non-Blooming Houseplant – under 12” tall overall (state variety)
- 80 Large Non-Blooming Houseplant – over 12” tall overall (state variety)
- 81 Ferns and Fern-Allies (Spore-producing vascular plants) (state variety)
- 82 Mixed Interior Planter – 2 or more varieties (state varieties)
- 83 Cactus (state variety)
- 84 Other Succulent (state variety)
- 85 Bonsai (state variety)
- 86 Orchids (state variety)
- 87 Outdoor Planter – 1 variety of plant (state variety)
- 88 Outdoor Planter – 2 or more varieties of plants (state varieties)
- 90 Vining Houseplant or Trailing Houseplant (state variety)
- 91 Hanging Basket – Single variety – indoor or outdoor (state variety)
- 92 Hanging Basket – Multiple varieties – indoor or outdoor (state varieties)



## 2024 Douglas County Fair & Rodeo Competition Rules

### HELPFUL HINTS

- A. Should be groomed to remove spent blossoms, damaged leaves, dirt, debris, and insects. Planting medium should not be visible or should play an aesthetic role in display. Container should be full to overflowing, and in proportion to contents.
- B. Plant container/pot does not count toward height in houseplant category.
- C. Outdoor Planters can be a mixture of annuals (including vegetables) and perennials.

### III. PREMIUMS

- A. All Floriculture Classes
  1. Ribbons will be awarded in 1<sup>st</sup> thru 6<sup>th</sup> place
  2. **PREMIUMS:** 1<sup>st</sup>-\$5, 2<sup>nd</sup>-\$3, 3<sup>rd</sup>-\$1
  3. Rosette: Best of Show, awarded for the Following Categories:
    - a. Overall Best of Show, Floriculture
    - b. Overall Youth Best of Show, Floriculture
    - c. Best Coneflower (classes 39-41)
    - d. Best Marigold (classes 16-17)
    - e. Best Dahlia (classes 66-68)
    - f. Best Rose (classes 52-57)
    - g. Best Wildflower (various classes, native plants or cultivars of plants native to Colorado region)
    - h. Most Fragrant (blue ribbon from any class)
    - i. Best Arrangement (classes 1-8)
    - j. Best Houseplant (classes 74-81; 83-86; 90)
    - k. Most Floriculture Entries
    - l. Best of the Most, Floriculture (Most Ribbons Awarded for Floriculture Entries)

## CREATIVE ARTS - OPEN CLASS DIVISION

ALL EXHIBITS ARE IN THE EVENTS CENTER - JUDGING CLOSED TO PUBLIC

ENTRY DATE: 7/28/24, 10A – 4P; EXHIBIT RELEASE/PREMIUM PAYMENT DATE: 8/4/24, 5-6P

VIEWER'S CHOICE BALLOTS DUE 8/3/24, 6PM

## FINE ARTS - DEPARTMENT FA

### I. DEPARTMENT PROVISIONS

- A. All entrants must read and be familiar with and comply with the Douglas County Fair & Rodeo General Competition Rules, Open Class Division General Competition Rules, and any special Division or Department Competition Requirements or Regulations.
- B. Exhibitors are allowed 2 entries per class in the Department.
  1. Youth exhibitors can enter any numbered class listed below as a youth and be judged against other youth in that class.
  2. Youth exhibitors can also enter by their grade completed as of August 1 of the current year and would be judged with a variety of entries and grades.
  3. Youth exhibitors can also enter against adult exhibitors (not common).
- C. Exhibitor Classification: The amateur and professional definitions are applied to the classes being entered. A person may be both an amateur and a professional (Ex: In the Crafts Department an exhibitor can be a professional in Stained Glass but an amateur in the Macrame. Professionals are not eligible for Best of Show or Best of Category awards.

**Amateur** – A person who engages in an activity as a hobby, not as a job.  
**Professional** – A person with professional training; or an instructor; or a person who participates for gain or livelihood in an activity often engaged in by amateurs; or a person who pursues the activity as a full-time occupation.
- D. For more information call: 720-733-6900.

### II. PREMIUMS

- A. All Classes
  1. Entries will be judged and awarded on merit. Ribbons may be awarded for 1st thru 6th place.
  2. Premiums: 1st-\$5, 2nd-\$3 3rd-\$1
  3. Rosette: Best of Show classes:
    - Open Fine Arts, classes 1-16
    - Youth Fine Arts, classes 1-54

### **FINE ARTS – DEPARTMENT FA**

- A. Exhibitors must use the following guidelines for framing and hanging artwork:

**Adult and Professional Division**: All Two-Dimensional Artwork **must** be ready to hang, dry, suitably framed, or matted and framed, and properly fitted with screw eyes or “D” rings and flexible picture hanging wire only. See examples shown below.

## 2024 Douglas County Fair & Rodeo Competition Rules

Oil paintings and acrylic-painted gallery-wrapped canvases must be dry at the time of entry and ready to hang using proper hanging materials as described with screw eyes or “D” rings and flexible picture hanging wire only.

**Youth Division:** All 2-D artwork **must** be matted and backed with cardboard or matboard. The mat and backing board must be sturdy enough to keep the artwork flat while it is hanging. No hanger is required, as we will furnish and use binder clips to hang the artwork, as shown in the examples below.

If the youth exhibitor chooses to frame, or mat and frame their work, they **must** follow the same hanging system requirements as described above in the Adult and Professional guidelines. If the youth exhibitor decides to compete in Adults and Professional division, they must follow the same hanging system requirements described in the Adult and Professional guidelines.

**All Entrants:** All artwork using clip mounts, string, tape, sawtooth hangers, hook holders embedded in cardboard backing, cardboard loops, or any other unstable hanging hardware, including missing wires, will not be accepted. Items that fall will be removed from view for the remainder of the fair for safety reasons.

Customary care will be taken in handling artwork, but it will be shown at the artist’s own risk.

- B. Fine Arts entries will be judged on technique, composition, color theory, originality, and overall presentation.
- C. Only traditional forms of fine art will be accepted and judged. **Entries must be original work designed and executed solely by the artist.** Work from commercial kits, paint-by-numbers or copied forms is not eligible. Digital or computer enhanced work will not be accepted or judged.

### CLASSES

#### Class Description

- 1 Abstract
- 2 Acrylic - Nature, incl. landscapes, flowers, etc.
- 3 Acrylic - Miscellaneous
- 4 Drawing I – Pencil, Graphite, Colored Pencil, Charcoal
- 5 Drawing II – Ink, Pen and Ink, Colored Markers
- 6 Drawing, Other – Scratchboard, Calligraphy, Crayon, Chalk, etc.
- 7 Mixed Media and Collage
- 8 Pastels
- 9 Printmaking - Woodcut, Linocut, Intaglio, Silkscreen, Lithography, Embossing, Oil
- 10 Oil Painting – Animal
- 11 Oil Painting – Miscellaneous
- 12 Sculpture
- 13 Water Based Media Painting – Watercolor, Tempera, Gouache, Alcohol Inks, Asian Brush Painting, etc.
- 14 Wildlife – Any Media
- 15 Miniature framed artwork – 4” x 4” or less, any media

# 2024 Douglas County Fair & Rodeo Competition Rules

16 Miscellaneous

## YOUTH CLASSES BY GRADE

Class	Description
50	Pre-K-Kindergarten
51	Grades 1st– 3rd
52	Grades 4th – 6th
53	Grades 7th – 9th
54	Grades 10th – 12th

### FRAMING HARDWARE AND HANGER EXAMPLES

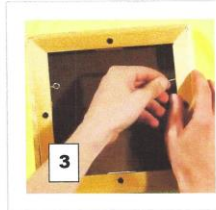
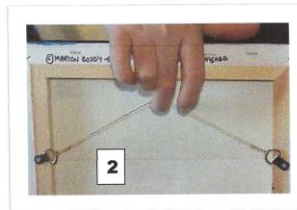

1. Screw eye and "D"-ring (with screw) to attach to back of frame
2. Example of D-rings and wire
3. Example of installing screw eyes
4. Binder clip holding artwork
5. Pegboard-mounted binder clip with attached matted artwork



## CRAFTS & CERAMICS DEPARTMENTS - CR

ALL EXHIBITS ARE IN THE EVENTS CENTER – JUDGING CLOSED TO THE PUBLIC

ENTRY DATE: 7/28/24, 10A – 4P; EXHIBIT RELEASE/PREMIUM PAYMENT DATE: 8/4/24, 5-6P

VIEWER'S CHOICE BALLOTS DUE 8/3/24, 6PM

### I. DEPARTMENT PROVISIONS

1. All entrants must read and be familiar with and comply with the Douglas County Fair & Rodeo General Competition Rules, Open Class Division General Competition Rules, and any special Division or Department Competition Requirements or Regulations.
2. Exhibitors are allowed 2 entries per class in the Department.
  - ii. Youth exhibitors can enter any numbered class listed below as a youth and be judged against other youth in that class.
  - iii. Youth exhibitors can also enter by their grade completed as of August 1 of the current year and would be judged with a variety of entries and grades.
  - iv. Youth exhibitors can also choose to enter against adult exhibitors (not common).
3. For more information call: 720-733-6900.
4. Articles **must** be clean and free from odor and pet hair.
5. Exhibitor Classification: The amateur and professional definitions are applied to the class being entered. A person may be both an amateur and a professional (Ex: In the Crafts Department an exhibitor can be a professional in Stained Glass but an amateur in the Macrame. Professionals are not eligible for Best of Show or Best of Category awards.
  - a. **Amateur** – A person who engages in an activity as a hobby, not as a job.
  - b. **Professional** – A person with professional training; or an instructor; or a person who participates for gain or livelihood in an activity often engaged in by amateurs; or a person who pursues the activity as a full-time occupation.

### II. PREMIUMS

#### A. All Classes

1. Entries will be judged and awarded on merit. Ribbons may be awarded for 1st thru 6th place.
2. Premiums: 1st-\$5, 2nd-\$3 3rd-\$1
3. Rosette: Best of Show classes:
  - Open Crafts, classes 306-336
  - Youth Crafts, classes 306-336 and 350 – 359
  - Open Beading, classes 300 - 305
  - Open Ceramics, classes 337 - 344
  - Youth Ceramics, classes 337 – 344 and 360 – 364

### CRAFTS - DEPARTMENT CR

#### A. Definition: Woodworking, Ceramics, etc.

1. (R) Representational: recognizable subject matter or abstract.
2. (NR) Non-Representational: non-recognizable or non-objective.

## 2024 Douglas County Fair & Rodeo Competition Rules

3. Commercial kits will be grouped together and judged on skill, not creativity.
  4. Scrapbooking, 2 pages only, in plastic sleeves for protection.
  5. Lego exhibits must be attached and displayed on rigid base and solidly constructed (not heavy or too fragile) to allow for display.
- B. Greenware or Earthenware, Porcelain and Stoneware and Pottery entries must be cleaned and finished by the Exhibitor only.
- C. All pieces must be finished on the bottom. No felt or covering of any kind is allowed.
1. The bottom constitutes the flat portion plus the lip of the bottom.
  2. If the bottom is not finished or felt is attached to the bottom, the entry will be disqualified.
- D. Any piece that has been from the bisque (purchased from any retail outlet) stage but not finished by the entrant (glazed, fired, etc.) cannot be entered in the Ceramics Department. Those retail contemporary pieces of bisque must be entered in the Miscellaneous Craft, Class # 341.

### **CLASSES**

<b>Class</b>	<b>Description</b>
--------------	--------------------

300	Beading – Off loom bead weaving jewelry, original design (done with needle and thread)
301	Beading – Off loom weaving jewelry – kit /pattern (done with needle and thread)
302	Beading – Loomed
303	Beading – Off Loom 3D, Other
304	Beading – Stringing
305	Beading – Wire & Beads
306	Decorative Craft – Kit
307	Decorative Craft Original Design
308	Decorative Wall Hanging Kit
309	Decorative Wall Hanging Original Design
310	Jewelry – Metalsmithing
311	Jewelry – Miscellaneous
312	Macramé
313	Leathercraft – Kit
314	Leathercraft – Original design
315	Woodcraft – Pattern or Kit
316	Woodcraft – Original design
317	Legos
318	Holiday Craft – Kit
319	Holiday Craft – Original design
320	Stained Glass
321	Fused Glass
322	Dolls – Original design
323	Dolls
324	Decorative Painting
325	Rosemaling
326	Clothes Painting
327	Miniatures

## 2024 Douglas County Fair & Rodeo Competition Rules

- 328 Basketry
- 329 Southwest
- 330 Metal Work
- 331 Scrapbooking, Traditional
- 332 Scrapbooking, Digital
- 333 Woodworking, Turned
- 334 Paper Craft
- 335 Recycled
- 336 Miscellaneous Craft
- 337 Ceramic item – Fired finish
- 338 Ceramic item – Unfired finish
- 339 Ceramic item – Combination of finishes
- 340 Hand Built/Hand Thrown Ceramics
- 341 Miscellaneous Ceramics (pottery, china, porcelain – any single or combination techniques)
- 342 Earthenware/Stoneware Miscellaneous (ceramic, pottery – any single or combination of finishes/techniques)
- 343 Raku
- 344 Polymer Clay

### **YOUTH CLASSES BY GRADE**

- | <b>Class</b> | <b>Description</b>             |
|--------------|--------------------------------|
| 350          | Grades Pre-K - Kindergarten    |
| 351          | Grades 1 <sup>st</sup> – 3rd   |
| 352          | Grades 4th – 6th               |
| 353          | Grades 7th – 9 <sup>th</sup>   |
| 354          | Grades 10 <sup>th</sup> – 12th |

### **YOUTH CLOTHES PAINTING BY GRADE**

- | <b>Class</b> | <b>Description</b>                         |
|--------------|--|
| 355          | Grades Pre-K - Kindergarten                |
| 356          | Grades 1 <sup>st</sup> - 3rd               |
| 357          | Grades 4th – 6th                           |
| 358          | Grades 7th – 9 <sup>th</sup>               |
| 359          | Grades 10 <sup>th</sup> – 12 <sup>th</sup> |

### **YOUTH CERAMICS CLASSES BY GRADE**

- | <b>Class</b> | <b>Description</b>          |
|--------------|-----------------------------|
| 360          | Grades Pre-K - Kindergarten |

**2024 Douglas County Fair & Rodeo Competition Rules**

- 361 Grades 1<sup>st</sup> – 3rd
- 362 Grades 4th – 6th
- 363 Grades 7th – 9<sup>th</sup>
- 364 Grades 10<sup>th</sup> – 12<sup>th</sup>

March 27, 2024



## PHOTOGRAPHY – DEPARTMENT PH

Viewer's Choice Ballots Due the Saturday following Judging 6pm

ALL EXHIBITS ARE IN THE EVENTS CENTER - JUDGING CLOSED TO THE PUBLIC

ENTRY DATE: 7/28/24, 10A – 4P; EXHIBIT RELEASE/PREMIUM PAYMENT DATE: 8/4/24, 5-6P

VIEWER'S CHOICE BALLOTS DUE 8/3/24, 6PM

### I. DEPARTMENT PROVISIONS

A. All entrants must read and be familiar with and comply with the Douglas County Fair & Rodeo General Competition Rules, Open Class Division General Competition Rules, and any special Division or Department Competition Requirements or Regulations.

B. Exhibitors are allowed 2 entries per class in the Department.

1. Youth exhibitors can enter any numbered class listed below as a youth and be judged against other youth in that class.

2. Youth exhibitors can also enter by their grade completed as of August 1 of the current year and would be judged with a variety of entries and grades.

3. Youth exhibitors can choose to also enter against adult exhibitors (not common).

C. For more information call: 720-733-6900.

D. Exhibitor Classification: The amateur and professional definitions are applied to the class being entered. A person may be both an amateur and a professional (Ex: In the Crafts Department an exhibitor can be a professional in Stained Glass but an amateur in the Macrame. Professionals are not eligible for Best of Show or Best of Category awards.

**Amateur** – A person who engages in an activity as a hobby, not as a job.

**Professional** – A person with professional training; or an instructor; or a person who participates for gain or livelihood in an activity often engaged in by amateurs; or a person who pursues the activity as a full-time occupation.

### II. PREMIUMS

A. All Classes

1. Entries will be judged and awarded on merit. Ribbons may be awarded for 1<sup>st</sup> thru 6<sup>th</sup> place.

2. Premiums: 1st-\$5, 2nd-\$3 3rd-\$1

3. Rosette: Best of Show classes:

Open Photography, classes 200 – 261, and 270 -277

Youth Photography, classes 200 – 261; 270-277; 290 - 294

Douglas County Fair Photo, class 262

### PHOTOGRAPHY DEPARTMENT

A. Photos must be mounted on a black mat or paper only and suitable for hanging without additional frame. HINT: Use double sided tape instead of glue as glue does not adhere well.

## 2024 Douglas County Fair & Rodeo Competition Rules

- B. Overall size limit 11" x 14" black mat only. Only 5" x7" or 8" x10" prints are acceptable. NO names or watermarks are allowed on prints.
- C. Single picture entries only except for Story Telling class.
- D. Subject matter of entries must be appropriate for family friendly viewing.
- E. For Class 262 only: All photos entered in Douglas County Fair Class #262 become the property of Douglas County/Douglas County Fair Board and will not be returned. No exceptions. In addition to entering the actual physical paper printed photograph for judging and display photographs must also be supplied in digital format for use by Douglas County/Douglas County Fair & Rodeo. The photograph need not be taken with a digital camera; good quality scans of photographic prints are acceptable. Digital files may be requested after the Fair. By entering the contest, entrants grant The Douglas County Fair a royalty-free, worldwide, perpetual, nonexclusive license to display, distribute reproduce and create derivative works of the entries, in whole or in part, in any media now existing or subsequently developed, for any educational, promotional, publicity, exhibition, archival, scholarly, and all other standard Douglas County Fair purposes. Any photograph reproduced will include a photographer credit as feasible. The Douglas County Fair will not be required to pay any additional consideration or seek any additional approval in connection with such uses. For a photo in which a person is recognizable, you must secure a model release, prior to submissions, from the subject or, in the case of a minor, the subject's parent or guardian and provide it to the Douglas County Fair upon request.

### **OPEN PHOTOGRAPHY DIVISION CLASSES**

<b>Class</b>	<b>Description</b>
200	Portraits of People over 60
201	Portraits of People 41-60
202	Portraits of People 21-40
203	Portraits of People 5-20
204	Portraits of People Infant-4
205	Portraits of People (Group)
206	People – Personalities
207	People at Work
208	Anythng 4-H
210	Animals – Personalities
211	Animals – Domestic
212	Animals – Wild
213	Animals – Farm
214	Touch of Country
215	Fall
219	Nature- Mountains
220	Nature – Sunsets
221	Nature – Miscellaneous
222	Nature - Water
223	Winter
230	Sports
231	Clouds
232	Astronomy

## 2024 Douglas County Fair & Rodeo Competition Rules

- 240 Flowers
- 241 Bugs
- 242 Architecture – Man Made
- 243 Birds
- 244 Food
- 250 Fireworks
- 251 Patriotic
- 252 Other
- 253 Drone
- 258 Selfies
- 260 Douglas County – Distinct Landmarks
- 261 Famous Landmarks
- 262 Douglas County Fair & Rodeo Photo
- 270 Macro
- 271 Still Life
- 272 Black and White
- 273 Action Photo – Peak of Action
- 274 Digital (Altered) – Inc. Hand Painted
- 275 Story Telling – A Succession of Photos on One Theme
- 276 Lightning
- 277 Photo Bomb

### **YOUTH CLASSES BY GRADE**

- | <b>Class</b> | <b>Description</b>             |
|--------------|--------------------------------|
| 290          | Grades Pre-K - Kindergarten    |
| 291          | Grades 1 <sup>st</sup> – 3rd   |
| 292          | Grades 4th – 6th               |
| 293          | Grades 7th – 9 <sup>th</sup>   |
| 294          | Grades 10 <sup>th</sup> – 12th |

## BAKING - DEPARTMENT BK

ALL EXHIBITS ARE IN THE EVENTS CENTER - JUDGING CLOSED TO PUBLIC

ENTRY DATE: 7/28/24, 10A – 4P; EXHIBIT RELEASE/PREMIUM PAYMENT DATE: 8/4/24, 5-6P

VIEWER'S CHOICE BALLOTS DUE 8/3/24, 6PM

### I. DEPARTMENT PROVISIONS

- A. All entrants must read and be familiar with and comply with the Douglas County Fair & Rodeo General Competition Rules, Open Class Division General Competition Rules, and any special Division or Department Competition Requirements or Regulations.
- B. For Youth exhibitors only, write “J” and the age of the youth exhibitor on the upper right corner of the Exhibit Tag.
  1. Exhibitors are allowed 2 entries per class in the Department.
  2. Youth exhibitors can enter any numbered class listed below as a youth and be judged against other youth in that class.
  3. Youth exhibitors can also enter by their grade completed as of August 1 of the current year and would be judged with a variety of entries and grades.
  4. Youth exhibitors can also choose to enter against adult exhibitors (not common) .
- C. Exhibitor Classification: The amateur and professional definitions are applied to the class being entered. A person may be both an amateur and a professional (Ex: In the Crafts Department an exhibitor can be a professional in Stained Glass but an amateur in Macrame. Professionals are not eligible for Best of Show or Best of Category awards.

**Amateur** – A person who engages in an activity as a hobby, not as a job.

**Professional** – A person with professional training; or an instructor; or a person who participates for gain or livelihood in an activity often engaged in by amateurs; or a person who pursues the activity as a full-time occupation.
- D. For more information call: 720-733-6900.

### II. PREMIUMS

- A. All Classes
  1. Entries will be judged and awarded on merit. Ribbons may be awarded for 1st thru 6th place.
- B. Premiums: 1st-\$5, 2nd-\$3 3rd-\$1
- C. Rosette: Best of Show classes:
  - Open Yeast Baking, classes 11 – 23
  - Youth Yeast Baking, classes 11 – 23
  - Open Most Blue Ribbons, classes 1 – 76
  - Youth Most Blue Ribbons, classes 1 – 76 and 80 – 84
  - Open Commissioners Cookie Jar, class 101
  - Youth Commissioners Cookie Jar, class 100

## BAKING – DEPARTMENT BK

## 2024 Douglas County Fair & Rodeo Competition Rules

### Questions about Baking? Go to <https://extension.colostate.edu/publications-2/> and choose High Elevation Food Preparation

- A. No pumpkin, custard, or cream pies, no cheesecake, or cobblers.
- B. All baked products must be entered on disposable paper plates, disposable tin pans, or cardboard. Cakes must be displayed on flat, covered cardboard. NO GLASS DISHES OR PANS.
- C. There will be a sale of Baked goods during judging on a donation basis at the Events Center.

### QUICK BREADS

<b>Class</b>	<b>Description</b>
1	Biscuits – 6
2	Fruit Bread (with or without nuts) and Nut Bread – 1 loaf
3	Muffins - 6
4	Squash Bread – 1 loaf
5	Coffee Cake - 1
6	Corn Bread Muffins - 6
7	Tortillas - 6
8	Miscellaneous (1 loaf or 6)
9	Gluten Free (1 loaf or 6)

### YEAST AND SOURDOUGH BREADS

<b>Class</b>	<b>Description</b>
11	White Bread – 1 loaf
12	Whole Wheat Bread – 1 loaf
13	Multi-Grain Bread – 1 loaf
14	Rye Bread – 1 loaf
15	Dinner Rolls – 6
16	Batter Bread – 1 loaf
17	Sweet Rolls – 6
18	Raised Doughnuts – 6
19	Holiday Breads – 1 loaf
20	Home Ground Grain Breads – 1 loaf
21	Artisan Bread
22	Miscellaneous – 6 rolls or 1 loaf
23	Gluten Free – 1 loaf

### CAKES

<b>Class</b>	<b>Description</b>
30	Unfrosted Cake
31	Frosted Cake
32	Bundt Cake
33	Decorated (Cake or Form)
34	Cupcakes, 6
35	Brownies – 6
36	Miscellaneous (1 cake or 6)
37	Gluten Free (1 cake or 6)

## 2024 Douglas County Fair & Rodeo Competition Rules

### **COOKIES**

<b>Class</b>	<b>Description</b>
40	Rolled (cutout cookies) – 6
41	Molded, Shaped or Tea – 6
42	Drop – 6
43	Bar – 6
44	Chocolate Chip – 6
45	Refrigerator – 6
46	Peanut Butter – 6
47	Oatmeal – 6
48	Pressed Cookies – 6
49	No Bake – 6
50	Miscellaneous – 6
51	Nutritional – 6
52	Gluten Free – 6
<b>53</b>	<b>Decorated Cookies - 6</b>

### **PIES**

<b>Class</b>	<b>Description</b>
60	Apple
61	Cherry
62	Peach
63	Rhubarb
64	Berry
65	Miscellaneous
66	Gluten Free

### **CANDY**

<b>Class</b>	<b>Description</b>
70	Fudge – 6
71	Divinity – 6
72	Mints – 6
73	Brittles – 6
74	No Cook – 6
75	Miscellaneous – 6
76	Gluten Free – 6

### **YOUTH CLASSES BY GRADE**

<b>Class</b>	<b>Description</b>
80	Grades Pre-K - Kindergarten
81	Grades 1 <sup>st</sup> – 3 <sup>rd</sup>
82	Grades 4th – 6th
83	Grades 7th – 9 <sup>th</sup>

## 2024 Douglas County Fair & Rodeo Competition Rules

84 Grades 10<sup>th</sup> – 12<sup>th</sup>

### **COMMISSIONERS' COOKIE JAR**

<b>Class</b>	<b>Description</b>
--------------	--------------------

100	Junior Cookie Jar
-----	-------------------

101	Open Cookie Jar
-----	-----------------

- A. Presented before the Junior Livestock Sale.
- B. This exhibit is a container of assorted cookies made by one or more people from at least 4 different recipes.
- C. The container must be filled and contain at least 4 kinds of different cookies individually wrapped.
- D. Exhibitors must place one cookie of each kind on a small plate to accompany the exhibit so that the Judge does not need to open the container.
- E. Containers must be wide-mouthed of approximately one gallon or 64-ounce capacity and must be decorated as desired by exhibitor.
- F. No commercially decorated cookie jars will be accepted.
- G. Cookies will count as 50% of score and decorated container 50% of score.

### **PREMIUMS**

**A. Junior Cookie Jar Premiums: 1<sup>st</sup> - \$8, 2<sup>nd</sup> - \$6, 3<sup>rd</sup> - \$4, 4<sup>th</sup> - \$2**

**B. Open Cookie Jar Premiums: 1<sup>st</sup> - \$16, 2<sup>nd</sup> - \$12, 3<sup>rd</sup> - \$8, 4<sup>th</sup> - \$4**

## CANNING – DEPARTMENT CN

ALL EXHIBITS ARE IN THE EVENTS CENTER - JUDGING CLOSED TO PUBLIC

ENTRY DATE: 7/28/24, 10A – 4P; EXHIBIT RELEASE/PREMIUM PAYMENT DATE: 8/4/24, 5-6P

VIEWER'S CHOICE BALLOTS DUE 8/3/24, 6PM

### I. DEPARTMENT PROVISIONS

- A. All entrants must read and be familiar with and comply with the Douglas County Fair & Rodeo General Competition Rules, Open Class Division General Competition Rules, and any special Division or Department Competition Requirements or Regulations.
- B. Exhibitors are allowed 2 entries per class in the Department.
  1. Youth exhibitors can enter any numbered class listed below as a youth and be judged against other youth in that class.
  2. Youth exhibitors can also enter by their grade completed as of August 1 of the current year and would be judged with a variety of entries and grades.
  3. Youth exhibitors can also choose to enter against adult exhibitors (not common) .
- C. Exhibitor Classification: The amateur and professional definitions are applied to the class being entered. A person may be both an amateur and a professional (Ex: In the Crafts Department an exhibitor can be a professional in Stained Glass but an amateur in the Macrame. Professionals are not eligible for Best of Show or Best of Category awards.

**Amateur** – A person who engages in an activity as a hobby, not as a job.  
**Professional** – A person with professional training; or an instructor; or a person who participates for gain or livelihood in an activity often engaged in by amateurs; or a person who pursues the activity as a full-time occupation.
- D. For more information call: 720-733-6900.

### II. PREMIUMS

- A. All Classes
  1. Entries will be judged and awarded on merit. Ribbons may be awarded for 1st thru 6th place.
  2. Premiums: 1st-\$5, 2nd-\$3 3rd-\$1
  3. Rosette: Best of Show classes
    - Open Canned Goods, classes 1 – 229
    - Youth Canned Goods, classes 1 – 229 and 230-234

## CANNING – DEPARTMENT CN

**Questions about preserving foods? Go to Colorado State Extension office**  
**<https://apps.chhs.colostate.edu/preservesmart>**



## 2024 Douglas County Fair & Rodeo Competition Rules

**Recipes (ingredients and measurements only) are required for all canned and dried products.** The recipe **must** be affixed to the jar or container and **must** include **source of recipe (resource name, year published, and page number or date accessed online and website link)**, ingredients, preparation instructions, method, time, temperature, and source of recipe. All canned and dried foods must be preserved using recipes from resources which use the USDA recommendations for processing. All recipes must be from the most current version of your recipe resource and use canning information from 1994 or later. Acceptable resources include, but are not limited to: The USDA, University Extension publications and pectin package inserts. All preserved foods must be processed using recommendations for a high-altitude area.

**To be considered for judging, all canned food entries must be canned in a boiling water canner or pressure canner.** All **canned** products **must** be canned in standard brand name **clear, non-colored** glass canning jars and canned since last year's fair by the person in whose name they are entered. Jars should be in good condition with two-piece canning lids with band in good condition and a new flat lid (**reusable lids will not be accepted**).

All **canned** products must be labeled properly. Label must include: (see sample below)

- a. Name of Product
- b. Method of preparation (type syrup, style of pack)
- c. Method of processing (i.e., water bath, pressure canner – indicate weighted or dial gauge)
- d. Processing time, altitude, and pounds of pressure (p.s.i.)
- e. Date Canned (all entries must have been preserved since the last fair.

Sliced Peaches in Light Syrup  
Raw pack  
Boiling Water Canner  
Processed 40 minutes at 5,000 feet  
July 15, 2022

All **dried** foods should be displayed in appropriate storage containers (clear glass jars with rust free lids, heavy weight plastic food quality bags, vacuum sealed plastic food bags, etc.).

All **dried** foods must be labeled properly. Label must include: (see sample below)

- a. Name of Product
- b. Pretreatment used, if any
- c. Method of drying (oven or dehydrator)
- d. Total drying time
- e. Date dried
- f. Jerky recipes must use CSU recommended procedures. Deer and Elk meat are to include a copy of test results for Chronic Wasting Disease. Test is mandatory.

Apricots  
Ascorbic Acid Dipped  
Dehydrator Dried, 8 hours  
July 15, 2022

## 2024 Douglas County Fair & Rodeo Competition Rules

### **FRUITS**

<b>Class</b>	<b>Description</b>
100	Apples
101	Cherries – Sweet
102	Cherries – Sour
103	Rhubarb
104	Peaches
105	Pears
106	Plums
107	Apricots
108	Berries
109	Fruit Mix
110	Apple Sauce
111	Miscellaneous

### **VEGETABLES**

<b>Class</b>	<b>Description</b>
120	Green Beans
121	Wax Beans
122	Beets
123	Carrots
124	Corn
125	Mixed Vegetables
126	Tomatoes
127	Tomato Juice
128	Stewed Tomatoes
129	Peas
130	Miscellaneous

### **RELISHES**

<b>Class</b>	<b>Description</b>
140	Corn Relish
141	Chili Sauce
142	Piccalilli
143	Hot Pepper Sauce
144	Zucchini
145	Salsa
146	Miscellaneous

### **PICKLES**

<b>Class</b>	<b>Description</b>
150	Beet
151	Dill

## 2024 Douglas County Fair & Rodeo Competition Rules

- 152 Sweet
- 153 Sour
- 154 Bread and Butter
- 155 Watermelon
- 156 Dilled Beans
- 157 Zucchini
- 158 Mixed Vegetable
- 159 Fruit
- 160 Miscellaneous

### **BUTTERS**

<b>Class</b>	<b>Description</b>
--------------	--------------------

- |     |                       |
|-----|-----------------------|
| 170 | Apple Butter          |
| 171 | Peach Butter          |
| 172 | Plum Butter           |
| 173 | Miscellaneous Butters |

A. Made from fruit pulp cooked with sugar until thickened to a spreadable consistency.

### **JAMS**

<b>Class</b>	<b>Description</b>
--------------	--------------------

- |     |                   |
|-----|-------------------|
| 180 | Apricot Jam       |
| 181 | Peach Jam         |
| 182 | Plum Jam          |
| 183 | Raspberry Jam     |
| 184 | Strawberry Jam    |
| 185 | Berry Jam         |
| 186 | Cherry Jam        |
| 187 | Rhubarb Jam Mix   |
| 188 | Miscellaneous Jam |

A. (Less firm than Jelly but will hold its shape. Made from crushed or chopped fruits and sugar).

### **JELLIES**

<b>Class</b>	<b>Description</b>
--------------	--------------------

- |     |                       |
|-----|-----------------------|
| 190 | Apple Jelly           |
| 191 | Chokecherry Jelly     |
| 192 | Cherry Jelly          |
| 193 | Chokecherry Jelly Mix |
| 194 | Grape Jelly           |
| 195 | Plum Jelly            |
| 196 | Berry Jelly           |
| 197 | Rhubarb Jelly Mix     |
| 198 | Rhubarb Jelly         |
| 199 | Crabapple Jelly       |
| 200 | Miscellaneous Jelly   |

A. Semi-solid mix of fruit juice and sugar that is clear and firm enough to hold its shape.

## 2024 Douglas County Fair & Rodeo Competition Rules

### **PRESERVES**

<b>Class</b>	<b>Description</b>
--------------	--------------------

- |     |                         |
|-----|-------------------------|
| 201 | Apricot Preserves       |
| 202 | Cherry Preserves        |
| 203 | Peach Preserves         |
| 204 | Plum Preserves          |
| 205 | Strawberry Preserves    |
| 206 | Tomato Preserves        |
| 207 | Rhubarb Preserves       |
| 208 | Miscellaneous Preserves |

A. Made of small, whole fruits or uniform size pieces of fruits in clear, thick, slightly jellied syrup.

### **MARMALADES**

<b>Class</b>	<b>Description</b>
--------------	--------------------

- |     |                         |
|-----|-------------------------|
| 210 | Orange Marmalade        |
| 211 | Miscellaneous Marmalade |
| 212 | Miscellaneous Conserve  |

A. Small transparent pieces of fruit and peel in soft jelly. Conserves: Similar to jam, but always a mixture of fruit and usually has nuts and sometimes raisins.

### **MISCELLANEOUS**

<b>Class</b>	<b>Description</b>
--------------	--------------------

- |     |                                    |
|-----|------------------------------------|
| 220 | Noodles - Dry – 2 cup minimum      |
| 221 | Shaped Pasta – 2 cup minimum       |
| 222 | Dried Fruit – 6 pieces             |
| 223 | Dried Vegetables – 6 pieces        |
| 224 | Fruit Leather – 6 pieces           |
| 225 | Vinegar – 1 Jar                    |
| 226 | Dried Herbs, ¼ cup each of 3 herbs |
| 227 | Granola – 2 cup minimum            |
| 228 | Dried Soups – 2 cup minimum        |
| 229 | Dried Meat – 6 pieces              |

### **YOUTH CLASSES BY GRADE**

<b>Class</b>	<b>Description</b>
--------------	--------------------

- |     |                                |
|-----|--------------------------------|
| 230 | Grades Pre-K - Kindergarten    |
| 231 | Grades 1 <sup>st</sup> – 3rd   |
| 232 | Grades 4th – 6th               |
| 233 | Grades 7th – 9 <sup>th</sup>   |
| 234 | Grades 10 <sup>th</sup> – 12th |

## HOME ARTS – DEPARTMENT HA

ALL EXHIBITS ARE IN THE EVENTS CENTER - JUDGING CLOSED TO PUBLIC

ENTRY DATE: 7/28/24, 10A – 4P; EXHIBIT RELEASE/PREMIUM PAYMENT DATE: 8/4/24, 5-6P

VIEWER'S CHOICE BALLOTS DUE 8/3/24, 6PM

### I. DEPARTMENT PROVISIONS

- A. All entrants must read and be familiar with and comply with the Douglas County Fair & Rodeo General Competition Rules, Open Class Division General Competition Rules, and any special Division or Department Competition Requirements or Regulations.
- B. Exhibitors are allowed 2 entries per class in the Department.
  - 1. Youth exhibitors can enter any numbered class listed below as a youth and be judged against other youth in that class.
  - 2. Youth exhibitors can also enter by their grade completed as of August 1 of the current year and would be judged with a variety of entries and grades.
  - 3. Youth exhibitors can also choose to enter against adult exhibitors (not common).
- C. Articles **must** be clean and free from odor and pet hair.
- D. Exhibitor Classification: The amateur and professional definitions are applied to the class being entered. A person may be both an amateur and a professional (Ex: In the Crafts Department an exhibitor can be a professional in Stained Glass but an amateur in the Macrame. Professionals are not eligible for Best of Show or Best of Category awards.
  - Amateur** – A person who engages in an activity as a hobby, not as a job.
  - Professional** – A person with professional training; or an instructor; or a person who participates for gain or livelihood in an activity often engaged in by amateurs; or a person who pursues the activity as a full-time occupation.
- E. For more information call: 720-733-6900.

### II. PREMIUMS

- A. All Classes
  - 1. Entries will be judged and awarded on merit. Ribbons may be awarded for 1<sup>st</sup> thru 6<sup>th</sup> place.
  - 2. Premiums: 1st-\$5, 2nd-\$3 3rd-\$1
  - 3. Rosette: Best of Show classes:
    - Open Lace, class 23 - 25, 130 - 131
    - Open Needlework, classes 75 - 85
    - Youth Needlework, classes 75 - 85 and 150 - 154
    - Open Embroidery, classes 50 - 62
    - Open Sewing, classes 1 - 13
    - Youth Sewing, classes 1 - 13 and 150 - 154
    - Open Knitting, classes 100 - 112
    - Open Crochet, classes 20 - 43
    - Open Afghan, classes 20 - 21, 100 - 101

**HOME ARTS – DEPARTMENT HA**

**SEWING**

<b>Class</b>	<b>Description</b>
1	Clothing
2	Children’s Clothing
3	Fashion Accessories
4	Toys
5	Aprons
6	Recycled Item
7	Costumes
8	Pillows
9	Wall Hanging
10	Kitchen Accessories
11	Bag
12	Quilted Item
13	Miscellaneous

**CROCHET**

<b>Class</b>	<b>Description</b>
20	Afghans
21	Afghans Baby
22	Slippers or Socks
23	Buffet Scarves
24	Doilies Under 14”
25	Doilies Over 14”
26	Dresses
27	Kitchen Accessories
28	Pillows
29	Toys
30	3-Piece Baby Set
31	Poncho or Shawl
32	Man’s Sweater
33	Woman’s Sweater
34	Child’s Sweater
35	Hat
36	Gloves or Mittens
37	Tablecloth
38	Scarves
39	Dolls
40	Holiday
41	Crocheted Item with beading
42	Baby
43	Miscellaneous

## 2024 Douglas County Fair & Rodeo Competition Rules

### **EMBROIDERY**

#### **Class Description**

- 50 Kitchen Accessories
- 51 Pillowcases – Pair
- 52 Pillow – Decorative
- 53 Crewel, Pillow, Needle Case or other item (afghan rare)
- 54 Crewel – Picture Under 8”
- 55 Crewel – Picture Over 8”
- 56 Beading – Surface (attach to fabric)
- 57 Beading – Necklaces
- 58 Beading – Bags
- 59 Ribbon Embroidery
- 60 Hand Embroidery
- 61 Machine Embroidery
- 62 Miscellaneous

### **NEEDLEWORK**

#### **Class Description**

- 75 Pillow – can have 1 or more counted techniques
- 76 Cross Stitch – Counted Under 4”
- 77 Cross Stitch – Counted Under 8”
- 78 Cross Stitch – Counted Over 8”
- 79 Cross Stitch – Stamped Under 4”
- 80 Cross Stitch – Stamped Under 8”
- 81 Cross Stitch – Stamped Over 8”
- 82 Needlepoint – Under 4”
- 83 Needlepoint – Under 8”
- 84 Needlepoint – Over 8”
- 85 Miscellaneous

### **KNITTING**

#### **Class Description**

- 100 Afghans
- 101 Afghans – Baby
- 102 3-Piece Baby Set
- 103 Ponchos or Shawls
- 104 Man’s Sweater

## 2024 Douglas County Fair & Rodeo Competition Rules

- 105 Woman's Sweater
- 106 Child's Sweater
- 107 Hats
- 108 Gloves or Mittens
- 109 Scarves
- 110 Slippers or Socks
- 111 Dresses
- 112 Miscellaneous

### **RUGS**

#### **Class Description**

- 120 Braided
- 121 Latch Hook
- 122 Punch
- 123 Knitted
- 124 Crochet
- 125 Hooked

### **MISCELLANEOUS**

#### **Class Description**

- 130 Tatting – Any
- 131 Lace – Any
- 132 Weaving
- 133 Felting
- 134 Hand Spinning

### **YOUTH CLASSES BY GRADE**

#### **Class Description**

- 150 Grades Pre-K - Kindergarten
- 151 Grades 1<sup>st</sup> – 3rd
- 152 Grades 4th – 6th
- 153 Grades 7th – 9<sup>th</sup>
- 154 Grades 10<sup>th</sup> – 12th



## QUILTS – DEPARTMENT Q

ALL EXHIBITS ARE IN THE EVENTS CENTER - JUDGING OPEN TO PUBLIC 7/29/24, 9AM

ENTRY DATE: 7/28/24, 10A – 4P; EXHIBIT RELEASE/PREMIUM PAYMENT DATE: 8/4/24, 5-6P

VIEWER'S CHOICE BALLOTS DUE 8/3/24, 6PM

### IV. DEPARTMENT PROVISIONS

- A. All entrants must read and be familiar with and comply with the Douglas County Fair & Rodeo General Competition Rules, Open Class Division General Competition Rules, and any special Division or Department Competition Requirements or Regulations.
- B. Exhibitors are allowed 2 entries per numbered class in the Department.
- C. First time entries must be identified on the entry tag.
- D. Articles **must** be clean and free from odor and pet hair. Please cover name labels attached to quilts.
- E. Youth Exhibitors:
  1. Youth exhibitors can enter any numbered class listed below as a youth and be judged against other youth in that class.
  2. Youth exhibitors can also enter by their grade completed as of August 1 of the current year and would be judged with a variety of entries and grades.
  3. Youth exhibitors can also choose to enter against adult exhibitors (not common) .
- F. Exhibitor Classification: The amateur and professional definitions are applied to the class being entered. A person may be both an amateur and a professional (Ex: In the Crafts Department an exhibitor can be a professional in Stained Glass but an amateur in the Macrame. Professionals are not eligible for Best of Show or Best of Category awards.

**Amateur** – A person who engages in an activity as a hobby, not as a job.

**Professional** – A person with professional training; or an instructor; or a person who participates for gain or livelihood in an activity often engaged in by amateurs; or a person who pursues the activity as a full-time occupation.
- G. Quilt:
  1. Three Layers – top, batting, backing.
  2. Held together by quilting stitches through all three layers.
- H. **Quilt Classifications:**
  1. **Large Quilts:** Those that have a total perimeter measurement of 280” or larger.
  2. **Small Quilts:** Those that have a total perimeter measurement of less than 280”.
  3. **Hand Quilted:** Quilts that are 75% hand quilted. Hand quilted quilts may include some machine quilting.
  4. **Machine Quilted:** Quilts that are 75% machine quilted. Machine quilts may include some hand quilting.
  5. **Mostly Pieced:** At least 75% of the surface of the quilt top is pieced by hand or machine.
  6. **Mostly Appliquéd:** At least 75% of the surface of the quilt top consists of appliquéd motifs applied by either hand or machine. Includes fused applique.
  7. **Mixed Techniques (pieced & appliquéd):** Any quilt top that consists of a fairly equal combination of piecing and appliquéd.

## 2024 Douglas County Fair & Rodeo Competition Rules

8. **Special Surface Design Techniques:** Quilts that consist of one or more other surface techniques such as embroidery (hand or machine), whole cloth, embellishments, photo transfers, memory quilts, panels, etc.
  9. **Miniature Quilts:** Quilts that are tiny scaled representations of full-size quilts. The piecing, applique motifs, fabric prints, quilting design, sashing, borders, and binding must all be miniature. Maximum perimeter measurement must be 70" or less. All surface techniques, quilting and finishing should be miniature in scale.
  10. **Group Quilts:** Combined efforts of three or more persons. At least one person must still be living.
  11. **Junior Quilts:** If 75% or more of a quilt is made by a Junior (age 18 or under) in collaboration with an adult, it may be entered in the Junior Quilts Division.
  12. **Art Quilt:** A contemporary artwork of original design involving the creative expression and exploration of various processes such as dyeing, printing, painting, stitching, embellishing, quilting, and weaving. An Art Quilt does not follow traditional block lines.
- I. For more information call: 720-733-6900.

## V. PREMIUMS

### A. All Classes

1. Entries will be judged and awarded on merit. Ribbons may be awarded for 1st thru 6th place.
2. Premiums: 1st-\$5, 2nd-\$3 3rd-\$1
3. Rosette: Best of Show classes
  - Open Quilts, Classes A1&2 – R1&2
  - Youth Quilts, Classes A1&2- R1&2, Y1 – Y5
  - Rosette: Best of Category classes
    - Large Quilt, Classes A1&2, B1&2, C1&2, D1&2, E1&2, L1&2, M1&2
    - Small Quilt, Classes F1&2, G1&2, H1&2, I1&2, J1&2, N1&2, O1&2
    - Quilted by Exhibitor, Classes A1 – P1
    - Quilted NOT by Exhibitor, Classes A2 – P2
    - Mostly Pieced, Classes A1&2, F1&2, L1&2, N1&2
    - Mostly Appliqued, Classes B1&2, C1&2, G1&2, H1&2, M1&2, O1&2

## QUILTS – DEPARTMENT Q

### A - LARGE QUILTS – MOSTLY PIECED

#### Class Description

- |    |                          |
|----|--------------------------|
| A1 | Quilted by Exhibitor     |
| A2 | Quilted-Not by Exhibitor |

### B - LARGE QUILTS – HAND APPLIQUE

#### Class Description

## 2024 Douglas County Fair & Rodeo Competition Rules

- B1 Quilted by Exhibitor
- B2 Quilted Not by Exhibitor

### **C - LARGE QUILTS – MOSTLY MACHINE APPLIQUE**

**Class Description**

- C1 Quilted by Exhibitor
- C2 Quilted Not by Exhibitor

### **D - LARGE QUILTS – MIXED TECHNIQUES**

**Class Description**

- D1 Quilted by Exhibitor
- D2 Quilted – Not by Exhibitor

### **E –LARGE QUILTS SPECIAL SURFACE TECHNIQUES**

**Class Description**

- E1 Quilted by Exhibitor
- E2 Quilted Not by Exhibitor

### **F - SMALL QUILTS –MOSTLY PIECED**

**Class Description**

- F1 Quilted by Exhibitor
- F2 Quilted Not by Exhibitor

### **G - SMALL QUILTS – HAND APPLIQUE**

**Class Description**

- G1 Quilted by Exhibitor
- G2 Quilted Not by Exhibitor

### **H - SMALL QUILTS – MOSTLY MACHINE APPLIQUE**

**Class Description**

- H1 Quilted by Exhibitor
- H2 Quilted Not by Exhibitor

### **I - SMALL QUILTS - MIXED TECHNIQUES**

**Class Description**

- I1 Quilted by Exhibitor
- I2 Quilted Not by Exhibitor

### **J - SMALL QUILTS – SPECIAL SURFACE TECHNIQUES**

**Class Description**

- J1 Quilted by Exhibitor
- J2 Quilted Not by Exhibitor

### **K HAND QUILTED – ANY SIZE – ANY TECHNIQUE (INCLUDES APPLIQUE, PIECED AND TIED QUILTS)**

## 2024 Douglas County Fair & Rodeo Competition Rules

### **Class Description**

- K1 Quilted by Exhibitor
- K2 Quilted Not by Exhibitor

### **L - GROUP QUILT (3 OR MORE PEOPLE) – LARGE MOSTLY PIECED**

#### **Class Description**

- L1 Quilted by Exhibitor
- L2 Quilted Not by Exhibitor

### **M - GROUP QUILT (3 OR MORE PEOPLE) – LARGE MOSTLY APPLIQUED**

#### **Class Description**

- M1 Quilted by Exhibitor
- M2 Quilted Not by Exhibitor

### **N – GROUP QUILT (3 OR MORE PEOPLE) – SMALL MOSTLY PIECED**

#### **Class Description**

- N1 Quilted by Exhibitor
- N2 Quilted Not by Exhibitor

### **O - GROUP QUILT (3 OR MORE PEOPLE) – SMALL MOSTLY APPLIQUED**

#### **Class Description**

- O1 Quilted by Exhibitor
- O2 Quilted Not by Exhibitor

### **P - MINIATURE QUILTS – ANY TECHNIQUE**

#### **Class Description**

- P1 Quilted by Exhibitor
- P2 Quilted Not by Exhibitor

### **Q - QUILTED CLOTHING**

- Q1 Quilted by Exhibitor
- Q2 Quilted Not by Exhibitor

### **R - QUILTED ACCESSORIES HOUSEHOLD ITEMS**

- R1 Quilted by Exhibitor
- R2 Quilted Not by Exhibitor

### **S - ART QUILTS – ORIGINAL DESIGN ONLY**

- S1 Quilted by Exhibitor
- S2 Quilted Not by Exhibitor

### **Y - YOUTH QUILTS BY GRADE**

- Y1 Grades Pre-K - Kindergarten
- Y2 Grades 1<sup>st</sup> – 3<sup>rd</sup>

## 2024 Douglas County Fair & Rodeo Competition Rules

- Y3 Grades 4<sup>th</sup> – 6<sup>th</sup>
- Y4 Grades 7<sup>th</sup> – 9<sup>th</sup>
- Y5 Grades 10<sup>th</sup> – 12<sup>th</sup>

### FIRST TIME COMPETITION ENTRY AWARDS DIVISION

PRESENTED BY: COLORADO QUILTING COUNCIL



In recognition of First Time Entries, the Colorado Quilting Council will present a ribbon for one adult and a ribbon for one youth provided the following criteria are met:

1. The entrant is entering the Douglas County Fair competition for the first time. (There is no requirement for the entry to be the first quilt that the entrant made.)
2. The entry is entirely the work of the entrant, including the quilting.
3. Youth: Under 18 years old
4. Adult: 18 years or older as of August 1 of the current year

## SENIORS - DEPARTMENT S

ALL EXHIBITS ARE IN THE EVENTS CENTER - JUDGING CLOSED TO PUBLIC

ENTRY DATE: 7/28/24, 10A – 4P; EXHIBIT RELEASE/PREMIUM PAYMENT DATE: 8/4/24, 5-6P

VIEWER'S CHOICE BALLOTS DUE 8/3/24, 6PM

### I. DEPARTMENT PROVISIONS

- A. All entrants must read and be familiar with and comply with the Douglas County Fair & Rodeo General Competition Rules, Open Class Division General Competition Rules, and any special Division or Department Competition Requirements or Regulations.
- B. Articles must be entered in the name of the person who made them
- C. Exhibitors are allowed 2 entries per numbered class in the Department
- D. Decision of the judges are final and not eligible for protest
- E. Exhibitors must be 55 years of age or older to enter in the Seniors Department
- F. Articles **must** be clean and free from odor and pet hair. Please cover name labels attached to quilts.
- G. Exhibitor Classification: The amateur and professional definitions are applied to the classes being entered. A person may be both an amateur and a professional (Ex: In the Crafts Department an exhibitor can be a professional in Stained Glass but an amateur in the Macrame. Professionals are not eligible for Best of Show or Best of Category awards.  
**Amateur** – A person who engages in an activity as a hobby, not as a job.  
**Professional** – A person with professional training; or an instructor; or a person who participates for gain or livelihood in an activity often engaged in by amateurs; or a person who pursues the activity as a full-time occupation.
- H. For more information call: 720-733-6900.

### II. PREMIUMS

- A. All Classes
  1. Entries will be judged and awarded on merit. Ribbons may be awarded for 1st thru 6th place.
  2. Premiums: 1st-\$5, 2nd-\$3 3rd-\$1
  3. Rosette: Best of Show classes:
    - Crafts, classes 21 – 30, 32 – 33, 35
    - Quilt, classes 11 - 13
    - Most Unique Recycled, class 34
    - Oldest Exhibitor, Resident, classes 1 -35
    - Senior with Most Entries, classes 1 - 35
    - Crocheted Item, classes 2, 4
    - Knitted Item, classes 1, 5
- B. Exhibitors must use the following guidelines for framing and hanging artwork.

All Two-Dimensional Artwork **must** be read to hang, dry, suitably framed, or matted and framed, and properly fitted with screw eyes or “D” rings and flexible picture hanging wire only. See examples shown below.

## 2024 Douglas County Fair & Rodeo Competition Rules

Oil paintings and acrylic-painted gallery-wrapped canvases **must** be dry at the time of entry and ready to hang using proper hanging materials as described with screw eyes or “D” rings and flexible hanging wire only.

- C. All artwork using clip mounts, string, tape, sawtooth hangers, hook holders embedded in cardboard backing, cardboard loops, or any other unstable hanging hardware, including missing wires, will not be accepted. Items that fall will be removed from view for the remainder of the fair.
- D. Customary care will be taken in handling artwork, but it will be shown at the artist’s own risk.
- E. Photography: Photos must be mounted on a black mat or paper only and suitable for hanging without additional frame. HINT: Use double sided tape instead of glue as glue does not adhere well.
- F. Overall size limit 11” x 14” black mat only. Only 5” x7” or 8” x10” prints are acceptable. NO names or watermarks are allowed on prints.
- G. Subject matter of entries must be appropriate for family friendly viewing.

## **SENIORS – DEPARTMENT S**

### **CLASSES**

<b>Class</b>	<b>Description</b>
1	Afghans – Knitted
2	Afghans – Crocheted
3	Sewing
4	Crocheted Item
5	Knitted Item
6	Counted Cross Stitch
7	Needlepoint
8	Embroidery
9	Doilies
10	Kitchen Accessories
11	Quilts – Hand Quilted
12	Quilts – Machine Quilted
13	Quilts – Tied or Tacked
14	Quilted Items
15	Felting
16	Rugs
17	Artwork - Acrylic
18	Artwork – Watercolor
19	Artwork – Oil
20	Artwork – Other
21	Tole Painting
22	Textile Painting
22	Decorated Clothing
24	Crafts
25	Jewelry

## 2024 Douglas County Fair & Rodeo Competition Rules

- 26 Beading
- 27 Toys
- 28 Baskets
- 29 Ceramics
- 30 Holiday
- 31 Photography
- 32 Woodworking
- 33 Metal Work
- 34 Recycled
- 35 Miscellaneous

### FRAMING HARDWARE AND HANGER EXAMPLES

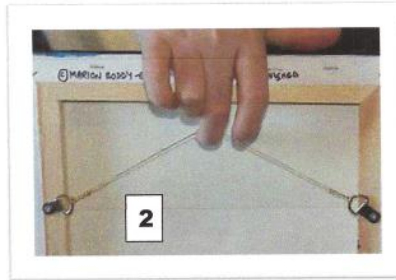

1. Screw eye and "D"-ring (with screw) to attach to back of frame
2. Example of D-rings and wire
3. Example of installing screw eyes
4. Binder clip holding artwork
5. Pegboard-mounted binder clip with attached matted artwork

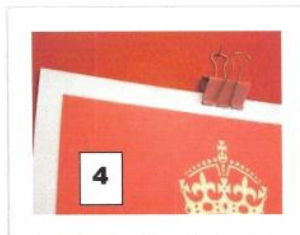





[www.FairAndRodeoFun.com](http://www.FairAndRodeoFun.com)